

REED PARK
IMPROVEMENTS
FRUITA, CO



ISSUE DATE: JUNE 15, 2023

REVISIONS

1 08/03/23 CD REVISION 1

DRAWN: KA REVIEWED: BM

PERMIT SET

PROJECT NUMBER: 6961

GENERAL NOTES

SHEET NUMBER

C1-00

GENERAL NOTES:

- 1. ALL WORK WITHIN PUBLIC RIGHTS-OF-WAY AND/OR EASEMENT AND ALL ON-SITE UTILITY WORK SHALL CONFORM TO THE TECHNICAL SPECIFICATIONS AND DESIGN CRITERIA FOR PUBLIC IMPROVEMENT PROJECTS OF THE CITY OF FRUITA AND THE GRANTOR OF THE EASEMENT.
2. ALL MATERIALS AND WORKMANSHIP SHALL BE IN CONFORMANCE WITH THE LATEST STANDARDS AND SPECIFICATIONS OF THE APPROPRIATE GOVERNING AGENCY.
3. THE EXISTING UTILITY LOCATIONS SHOWN ON THE PLANS ARE APPROXIMATE AND MAY NOT INCLUDE ALL LINES PRESENT.
4. LOCATIONS AND ELEVATIONS OF EXISTING IMPROVEMENTS TO BE MET (OR AVOIDED) BY WORK TO BE DONE SHALL BE CONFIRMED BY THE CONTRACTOR THROUGH FIELD EXPLORATIONS PRIOR TO CONSTRUCTION.
5. THE CONTRACTOR SHALL BE RESPONSIBLE FOR NOTIFYING THE APPROPRIATE FIRE DEPARTMENT OF ALL STREET CLOSURES AND EXISTING FIRE HYDRANTS TAKEN OUT OF SERVICE AT LEAST 48 HOURS PRIOR TO CONSTRUCTION.
6. ANY CONSTRUCTION DEBRIS OR MUD DROPPED INTO MANHOLES, INLETS, PIPES OR TRACKED ONTO EXISTING ROADWAYS SHALL BE REMOVED IMMEDIATELY BY THE CONTRACTOR.
7. EXCEPT FOR MATERIALS DESIGNED TO BE RELOCATED ON THIS PLAN, ALL OTHER CONSTRUCTION MATERIALS SHALL BE NEW.
8. NO WORK SHALL BE BACKFILLED (INCLUDING BEDDING MATERIAL ABOVE THE SPRING LINE OF THE PIPE) UNTIL THE CONSTRUCTION HAS BEEN INSPECTED AND APPROVED FOR BACKFILLING BY THE APPROPRIATE GOVERNING AGENCY.
9. ALL WORK AND MATERIALS WILL BE SUBJECT TO INSPECTION AND APPROVAL BY THE OWNER OR THE OWNERS REPRESENTATIVE.
10. SHOP DRAWINGS AND MATERIAL SPECIFICATIONS SHALL BE SUBMITTED TO OWNER/ENGINEER FOR REVIEW AND APPROVAL PRIOR TO PLACEMENT OF MATERIAL.
11. ALL WORK SHALL CONFORM TO ALL LOCAL, STATE, AND FEDERAL APPLICABLE LAWS AND REGULATIONS.
12. ALL ESTIMATES OF QUANTITIES ARE FOR INFORMATIONAL PURPOSES ONLY.
13. THE CONTRACTOR SHALL BE RESPONSIBLE FOR JOB SITE SAFETY OF HIS OWN PERSONNEL, ALL VISITORS TO THE SITE, AND THE GENERAL PUBLIC INCLUDING, BUT NOT LIMITED TO, TRENCH EXCAVATION AND SHORINGS, TRAFFIC CONTROL, AND SECURITY NOT LIMITED TO NORMAL WORKING HOURS.
14. THE CONTRACTOR SHALL BE RESPONSIBLE FOR REPAIRING ALL EXISTING FEATURES TO REMAIN THAT ARE DAMAGED DURING CONSTRUCTION ACTIVITIES TO EQUAL OR BETTER CONDITION, AT HIS OWN EXPENSE.
15. CONTRACTOR SHALL COORDINATE THE INSTALLATION OF ALL SITE IMPROVEMENTS INCLUDING BUT NOT LIMITED TO: UTILITIES, STRUCTURES, PAVING, LANDSCAPING, ETC.) SUCH THAT NO DAMAGE IS DONE TO SITE IMPROVEMENTS (I.E.: SAWCUTTING NEW PAVEMENT), SITE IMPROVEMENTS DAMAGED DURING CONSTRUCTION SHALL BE REPAIRED OR REPLACED TO THE SATISFACTION OF THE OWNER AT NO ADDITIONAL COST TO THE OWNER.
16. IF, DURING THE CONSTRUCTION PROCESS, CONDITIONS ARE ENCOUNTERED WHICH COULD INDICATE THAT A PRIOR UNIDENTIFIED SITUATION IS PRESENT, THE CONTRACTOR SHALL CONTACT THE ENGINEER IMMEDIATELY.
17. THE CONTRACTOR SHALL REMOVE ALL DEBRIS RESULTING FROM WORK UNDER THIS CONTRACT TO AN APPROVED DUMP SITE.
18. DIMENSIONS SHOWN ON THE PLANS ARE TO FACE OF CURB LINE IN CURBED AREA AND EXTERIOR FACE OF BUILDING, AND TO CENTERLINE OF UTILITIES, UNLESS OTHERWISE SPECIFIED.
19. USE ONLY DIMENSIONS PROVIDED ON THESE PLANS. DO NOT SCALE DRAWINGS. INFORM ENGINEER OF ANY DISCREPANCIES AND/OR MISSING INFORMATION.
20. THE CONTRACTOR SHALL BE RESPONSIBLE FOR MAINTAINING ACCESS TO ADJACENT PARCELS DURING ALL HOURS OF OPERATION FOR THE BUSINESSES LOCATED ON THOSE PARCELS.
21. CONTRACTOR TO REFER TO DRAWINGS ISSUED BY THE ARCHITECT, TO ENSURE COORDINATION OF EXACT LOCATION AND DIMENSIONS OF BUILDING EXITS, RAMPS, TRUCK DOCKS, UTILITY ENTRANCE LOCATIONS AND GRADES AROUND THE BUILDING. IMMEDIATELY NOTIFY ENGINEER AND ARCHITECT OF ANY DISCREPANCIES.
22. THE CONTRACTOR SHALL OBTAIN A COPY OF THE STANDARD SPECIFICATIONS AND DETAILS OF ALL AGENCIES EXERCISING JURISDICTION OVER THIS PROJECT. A COPY OF THESE SPECIFICATIONS AND DETAILS SHALL BE MAINTAINED ON THE JOBSITE AT ALL TIMES. A COPY OF ALL APPLICABLE STANDARD DETAILS AND SPECIFICATIONS ARE INCORPORATED HEREIN BY REFERENCE.
23. THE CONTRACTOR IS RESPONSIBLE FOR REMOVING EXISTING IRRIGATION SYSTEM IN THE AREAS OF PROPOSED IMPROVEMENTS. THE CONTRACTOR SHALL CAP THE EXISTING IRRIGATION SYSTEM TO REMAIN SUCH THAT THE REMAINING SYSTEM SHALL CONTINUE TO FUNCTION PROPERLY. IN CASES WHERE ISLAND, ROADWAYS, PARKING LOTS, AND OTHER IMPROVEMENTS NOT MENTIONED ARE MOVED OR ADJUSTED TO GRADE, CONTRACTOR SHALL BE RESPONSIBLE FOR ENSURING THAT ALL LANDSCAPED AREAS ARE PROPERLY IRRIGATED & THAT IRRIGATION SYSTEM FUNCTIONS PROPERLY.
24. THE CONTRACTOR SHALL BE RESPONSIBLE FOR KEEPING ADJACENT CITY STREETS FREE AND CLEAN OF ALL DEBRIS AND DIRT FROM THE JOB SITE.

GRADING:

- 1. THE CONTRACTOR IS RESPONSIBLE FOR PROTECTION OF ALL PROPERTY CORNERS. ANY PROPERTY CORNERS DISTURBED OR DAMAGED BY GRADING ACTIVITIES SHALL BE RESET BY A PROFESSIONAL LAND SURVEYOR LICENSED IN THE STATE OF COLORADO, AT THE CONTRACTORS EXPENSE.
2. THE CONTOUR LINES AND BUILDING FLOOR ELEVATIONS SHOWN ARE TO FINISH GRADE FOR SURFACE OF PAVEMENT, TOP OF SIDEWALKS AND CURBS, TOP OF FLOOR SLABS, ETC. ALL SPOT ELEVATIONS SHOWN ARE TO FINISHED GRADE UNLESS OTHERWISE INDICATED. REFER TO TYPICAL SECTIONS FOR MULCH, SOD, PAVING, SLAB AND AGGREGATE BASE THICKNESS TO DEDUCT FOR GRADING LINE ELEVATIONS.
3. TOP OF CURB AND SIDEWALK ELEVATIONS AT LOCATIONS OTHER THAN THE SIDEWALK AROUND THE BUILDING SHALL BE 0.5' ABOVE GUTTER ELEVATIONS UNLESS OTHERWISE NOTED. IN AREAS WITH SIDEWALK ABUTTING BACK OF CURB, TOP OF CURB ELEVATIONS SHALL BE EQUAL TO SIDEWALK ELEVATIONS.
4. THE CONTRACTOR SHALL FINISH GRADE SLOPES AS SHOWN NO STEEPER THAN ONE FOOT VERTICAL IN THREE FEET HORIZONTAL.
5. CONTRACTOR SHALL GRADE LANDSCAPED AREAS TO PROVIDE POSITIVE DRAINAGE AWAY FROM BUILDINGS AND SIDEWALKS WHEN FINISH LANDSCAPE MATERIALS ARE IN PLACE.
6. THE CONTRACTOR SHALL CLEAN OUT ALL EXISTING AND PROPOSED INLETS, PIPES AND MANHOLES OF DEBRIS AND SEDIMENT AT COMPLETION OF SITEWORK. THIS WORK SHALL BE DONE TO THE SATISFACTION OF THE OWNER.
7. CONTRACTOR SHALL COORDINATE TESTING ACTIVITIES WITH THE GEOTECHNICAL ENGINEER.
8. ALL GRADING, COMPACTION, AND PAVEMENT CONSTRUCTION WILL BE IN ACCORDANCE WITH RECOMMENDATIONS FROM THE GEOTECHNICAL INVESTIGATION.

ADA NOTES:

- 1. THE CONTRACTOR IS RESPONSIBLE FOR ENSURING THAT ALL ACCESSIBLE AREAS ARE BUILT IN ACCORDANCE WITH THE PLANS AND THE AMERICANS WITH DISABILITIES ACT ACCESSIBILITY GUIDELINES (ADAAG).
2. ALL ADA ACCESSIBLE PARKING SHALL BE CONSTRUCTED WITH A MAXIMUM SLOPE OF 2.00% IN ANY DIRECTION.
3. ALL ADA ACCESSIBLE ROUTES SHALL BE CONSTRUCTED WITH A MAXIMUM CROSS SLOPE OF 2.00% AND A MAXIMUM LONGITUDINAL SLOPE OF 5.00%.
4. ALL ADA MANEUVERING AREAS SHALL BE CONSTRUCTED WITH A MAXIMUM SLOPE OF 2.00% IN ANY DIRECTION.
5. ALL ADA ACCESSIBLE RAMPS SHALL MEET THE ADA REQUIREMENTS PER ADAAG SECTION 4.7 & 4.8.

EROSION & SEDIMENT CONTROL:

- 1. THESE CONSTRUCTION DRAWINGS ARE NOT COMPLETE WITHOUT THE MOST RECENTLY APPROVED STORMWATER MANAGEMENT (SWMP) PLANS.
2. THE CONTRACTOR SHALL INSTALL EROSION/SEDIMENTATION CONTROLS PRIOR TO ANY SITE PREPARATION WORK (E.G., CLEARING, GRUBBING, OR EXCAVATION).
3. THE PLACEMENT OF EROSION/SEDIMENTATION CONTROLS SHALL BE IN ACCORDANCE WITH THE OVERALL GRADING & EROSION CONTROL PLAN PREPARED FOR THE PROJECT.
4. CONTRACTOR TO ADJUST EROSION CONTROL MEASURES AS NEEDED FOR VARIOUS PHASES OF WORK.
5. CONTRACTOR TO ENSURE THAT NO DIRT AND SEDIMENT IS TRACKED ONTO ADJACENT STREETS AND WATERWAYS.
6. A GROUNDWATER DISCHARGE PERMIT IS REQUIRED FROM THE STATE ENGINEER'S OFFICE, PRIOR TO PUMPING IT OUT.
7. GROUNDWATER SHALL BE SAMPLED AND SENT TO AN APPROVED LABORATORY FOR TESTING PRIOR TO BEING DISCHARGED. TESTING SHALL BE IN ACCORDANCE WITH PERMIT FOR STORM WATER DISCHARGE.
8. APPROVED EROSION AND SEDIMENT CONTROL "BEST MANAGEMENT PRACTICES" (BMPs) SHALL BE MAINTAINED AND KEPT IN GOOD REPAIR FOR THE DURATION OF THIS PROJECT. AT A MINIMUM, THE CONTRACTOR SHALL INSPECT ALL BMPs EVERY 14 DAYS, AND AFTER ALL SIGNIFICANT PRECIPITATION EVENTS I.E. RAINFALL, SNOWMELT. ALL NECESSARY MAINTENANCE AND REPAIR ACTIVITIES SHALL BE COMPLETED WITHIN TWENTY-FOUR (24) HOURS AFTER DIRECTION BY EROSION CONTROL ADMINISTRATOR. ACCUMULATED SEDIMENT AND CONSTRUCTION DEBRIS SHALL BE REMOVED WEEKLY FROM ALL BMPs, OR AT ANY TIME THAT SEDIMENT OR CONSTRUCTION DEBRIS ADVERSELY IMPACTS THE FUNCTIONING OF THE BMPs.
9. TOPSOIL SHALL BE STOCKPILED WITHIN LIMITS OF CONSTRUCTION FOR USE ON AREAS TO BE RE-VEGETATED. ANY AND ALL STOCKPILES SHALL BE PLACED IN AN APPROVED LOCATION AND PROTECTED FROM EROSION ELEMENTS USING MEASURES SPECIFIED IN THE EROSION CONTROL PLAN.
10. SOILS THAT WILL BE STOCKPILED FOR MORE THAN THIRTY (30) DAYS SHALL BE MULCHED AND SEEDED WITH A TEMPORARY OR PERMANENT GRASS COVER WITHIN FOURTEEN (14) DAYS OF STOCKPILE CONSTRUCTION.
11. ANY SETTLEMENT OR SOIL ACCUMULATIONS BEYOND THE LIMITS OF CONSTRUCTION DUE TO GRADING OR EROSION SHALL BE REPAIRED IMMEDIATELY BY THE CONTRACTOR. THE CONTRACTOR SHALL BE HELD RESPONSIBLE FOR REMEDIATION OF ANY ADVERSE IMPACTS TO ADJACENT WATERWAYS, WETLANDS, PROPERTIES, ETC. RESULTING FROM WORK DONE AS PART OF THIS PROJECT.
12. A WATER SOURCE MUST BE AVAILABLE ON SITE DURING EARTHWORK OPERATIONS AND UTILIZED AS REQUIRED TO MINIMIZE DUST FROM EARTHWORK EQUIPMENT AND WIND.
13. THE CONTRACTOR MUST KEEP ALL POLLUTANTS, INCLUDING SEDIMENT, CONSTRUCTION DEBRIS, AND TRENCH BACKFILL MATERIALS FROM ENTERING THE STORM SEWER SYSTEM.
14. ALL SPILLS INCLUDING, BUT NOT LIMITED TO, PETROLEUM PRODUCTS, SOLVENTS, AND CEMENT SHALL BE CLEANED UP IMMEDIATELY. EROSION CONTROL ADMINISTRATOR SHALL BE NOTIFIED IMMEDIATELY.
15. THE CONTRACTOR SHALL ENSURE THAT ALL LOADS OF CUT AND FILL MATERIAL IMPORTED TO OR EXPORTED FROM THE SITE SHALL BE PROPERLY COVERED TO PREVENT LOSS OF THE MATERIAL DURING TRANSPORT ON PUBLIC RIGHT-OF-WAY.
16. THE CONTRACTOR SHALL ENSURE THAT ALL MATERIAL EXPORTED FROM THE SITE, IS DISPOSED OF AT A SITE PERMITTED TO ACCEPT SUCH MATERIAL.
17. THE USE OF REBAR, STEEL STAKES OR STEEL FENCE POSTS FOR STAKING DOWN STRAW OR HAY BALES, OR TO SUPPORT SILT FENCING USED AS AN EROSION CONTROL MEASURE, IS PROHIBITED.
18. THE CLEANING OF CONCRETE DELIVERY TRUCK CHUTES IS RESTRICTED TO APPROVED LOCATIONS ON THE JOB SITE. THE DISCHARGE OF WATER CONTAINING WASTE CEMENT TO THE STORM SEWER SYSTEM IS PROHIBITED. ALL CONCRETE WASTE SHALL BE PROPERLY CLEANED UP AND DISPOSED OF AT AN APPROPRIATE LOCATION.
19. PRIOR TO ACTUAL CONSTRUCTION, THE CONTRACTOR SHALL VERIFY THE LOCATION OF EXISTING UTILITIES. FOR INFORMATION, CONTACT THE UTILITY NOTIFICATION CENTER OF COLORADO AT 811.

UTILITIES:

- 1. CONTRACTOR TO FIELD VERIFY LOCATIONS AND SIZES OF ALL EXISTING UTILITIES BEFORE BEGINNING WORK.
2. THE CONTRACTOR SHALL COORDINATE EXACT LOCATIONS AND SIZES OF ALL UTILITY SERVICE LINE HOOKUPS TO THE BUILDINGS WITH THE MECHANICAL, ELECTRICAL AND PLUMBING PLANS AND SPECIFICATIONS, AND REPORT ANY DISCREPANCIES TO THE ENGINEER AND ARCHITECT PRIOR TO BEGINNING UTILITIES CONSTRUCTION.
3. THE CONTRACTOR SHALL CONSTRUCT THE SANITARY SEWER SERVICE CONNECTIONS IN ACCORDANCE WITH THE APPLICABLE STANDARDS AND SPECIFICATIONS OF THE CITY OF FRUITA.
4. THE CONTRACTOR SHALL CONSTRUCT ALL WATER SERVICE CONNECTIONS IN ACCORDANCE WITH THE APPLICABLE STANDARDS AND SPECIFICATIONS OF THE CITY OF FRUITA.
5. THE CONTRACTOR SHALL CONSTRUCT ALL ELECTRIC, GAS, TELEPHONE, AND CABLE TELEVISION SERVICES IN ACCORDANCE WITH THE APPLICABLE STANDARDS AND SPECIFICATIONS OF THE UTILITY PROVIDER.
6. ALL EXISTING SEWERS, PIPING AND UTILITIES SHOWN ARE NOT TO BE INTERPRETED AS THE EXACT LOCATION, OR AS THE ONLY OBSTACLES THAT MAY OCCUR ON THE SITE. VERIFY EXISTING CONDITIONS AND PROCEED WITH CAUTION AROUND ANY ANTICIPATED FEATURES. GIVE NOTICE TO ALL UTILITY COMPANIES REGARDING DESTRUCTION AND REMOVAL OF ALL SERVICE LINES AND CAP ALL LINES BEFORE PROCEEDING WITH THE WORK. UTILITIES DETERMINED TO BE ABANDONED AND LEFT IN PLACE SHALL BE GROUTED IF UNDER BUILDING.
7. ELECTRICAL, TELEPHONE, CABLE, WATER, FIBER OPTIC CABLE AND/OR GAS LINES NEEDING TO BE REMOVED OR RELOCATED SHALL BE COORDINATED WITH THE AFFECTED UTILITY COMPANY. ADEQUATE TIME SHALL BE PROVIDED FOR RELOCATION AND CLOSE COORDINATION WITH THE UTILITY COMPANY IS NECESSARY TO PROVIDE A SMOOTH TRANSITION IN UTILITY SERVICE.
8. UTILITY TRENCHES ARE TO BE SLOPED OR BRACED AND SHEETED AS NECESSARY FOR THE SAFETY OF THE WORKMEN AND THE PROTECTION OF OTHER UTILITIES IN COMPLIANCE WITH ALL APPLICABLE LOCAL, STATE AND FEDERAL REQUIREMENTS.
9. CONTRACTOR TO SET AND ADJUST ALL MANHOLE COVERS, INLET GRATES, WATER VALVES, CLEAN OUTS, AND ANY OTHER ACCESS COVERS TO FINISHED PAVEMENT SURFACE OR FINISHED GRADE.
10. ALL ON-SITE STORM DRAIN PIPES TO BE CLASS III RCP UNLESS OTHERWISE SPECIFIED.

**REED PARK
IMPROVEMENTS**
FRUITA, CO



ISSUE DATE: JUNE 15, 2023

NO.	DATE	DESCRIPTION
1	08/03/23	CD REVISION 1

DRAWN: KA REVIEWED: BM

PERMIT SET

PROJECT NUMBER: 6961

DEMOLITION PLAN

SHEET NUMBER

C1-01

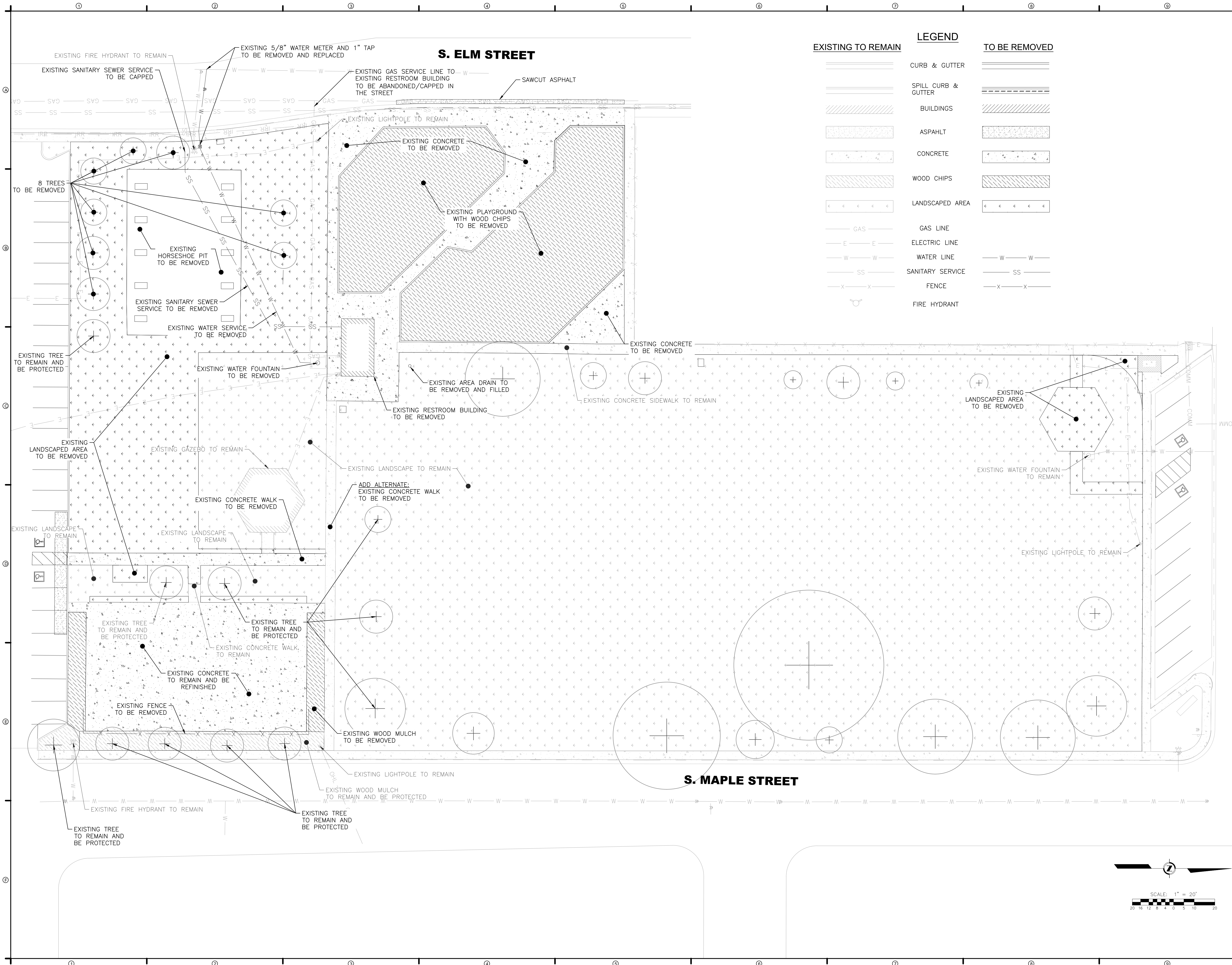

EXISTING TO REMAIN		LEGEND		TO BE REMOVED	
	CURB & GUTTER		SPILL CURB & GUTTER		BUILDINGS
	ASPAHLT		CONCRETE		WOOD CHIPS
	LANDSCAPED AREA		GAS LINE		ELECTRIC LINE
	WATER LINE		SANITARY SERVICE		FENCE
	FIRE HYDRANT				

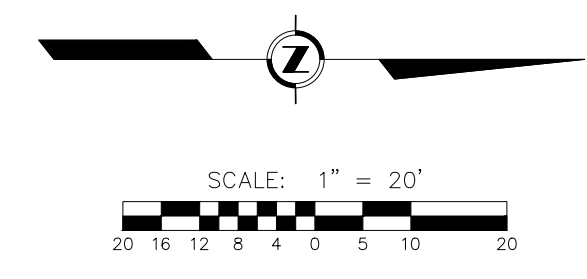

EXISTING UTILITY LOCATIONS: COLLINS ENGINEERS INC. ASSUMES NO RESPONSIBILITY FOR EXISTING UTILITY LOCATIONS (HORIZONTAL OR VERTICAL). THE EXISTING UTILITIES SHOWN ON THIS DRAWING HAVE BEEN PLOTTED FROM THE BEST AVAILABLE INFORMATION. IT IS HOWEVER THE RESPONSIBILITY OF THE CONTRACTOR TO FIELD VERIFY THE LOCATION OF ALL UTILITIES PRIOR TO THE COMMENCEMENT OF ANY CONSTRUCTION ACTIVITIES.

EXISTING	LEGEND	PROPOSED
	CURB & GUTTER	
	BUILDINGS	
	ASPAHLT	
	CONCRETE	
	GAS LINE	
	ELECTRIC LINE	
	WATER LINE	
	SANITARY SERVICE	
	STORM SEWER	
	PERFORATED UNDERDRAIN	
	CLEANOUT	
	FIRE HYDRANT	
	WATER METER	

DESIGNWORKSHOP
 Landscape Architecture • Land Planning
 Urban Design • Tourism Planning
 Aspen • Austin • Chicago • Denver • Houston
 Lake Tahoe • Los Angeles • Raleigh
 22860 Two Rivers Road
 Basalt, Colorado 81621
 (970) 925-8354
 WWW.DESIGNWORKSHOP.COM

**REED PARK
 IMPROVEMENTS**
 FRUITA, CO



ISSUE DATE: JUNE 15, 2023

REVISIONS	DATE	DESCRIPTION
1	08/03/23	CD REVISION 1

DRAWN: KA REVIEWED: BM

PERMIT SET

PROJECT NUMBER: 6961

UTILITY PLAN

SHEET NUMBER
C2-01

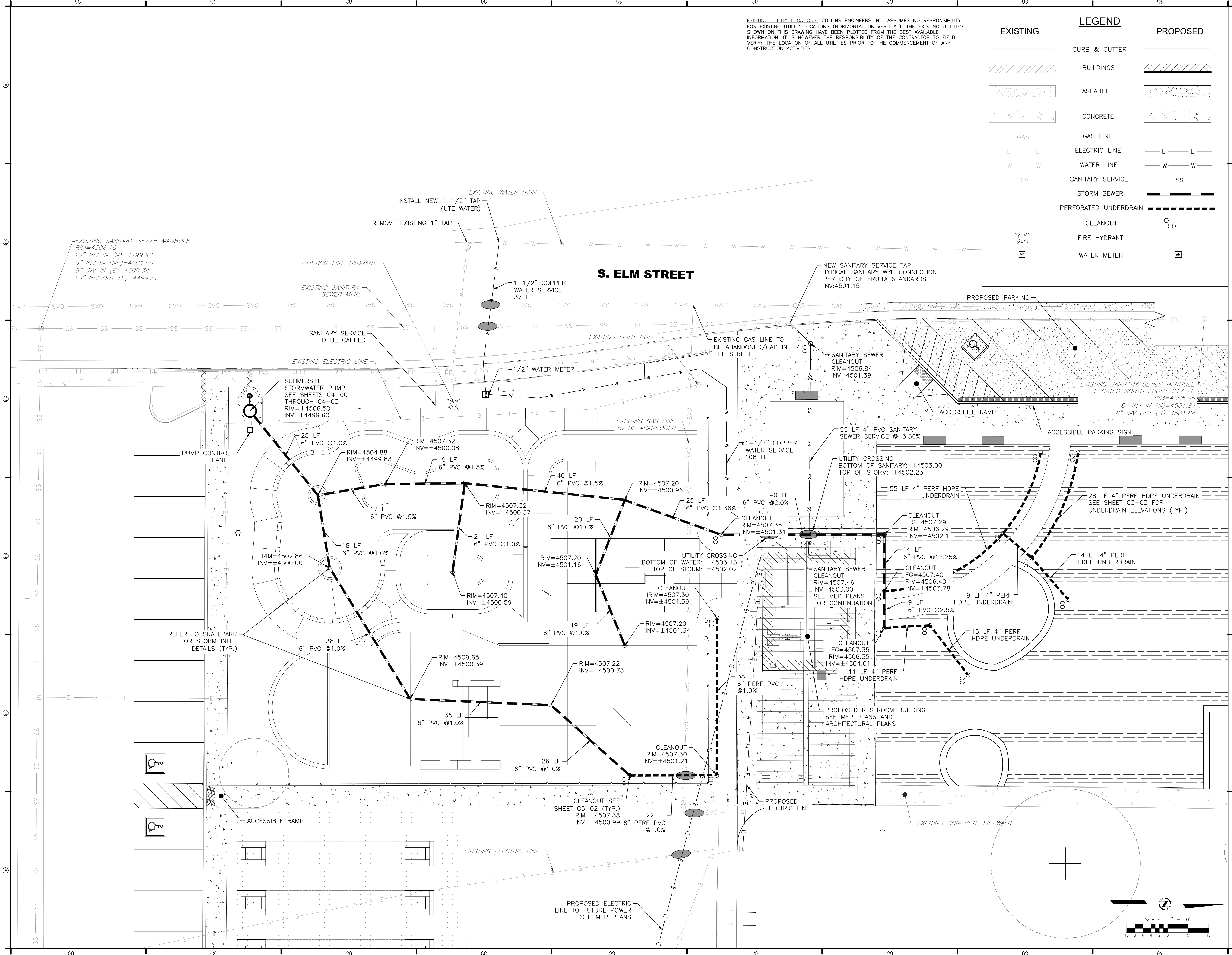

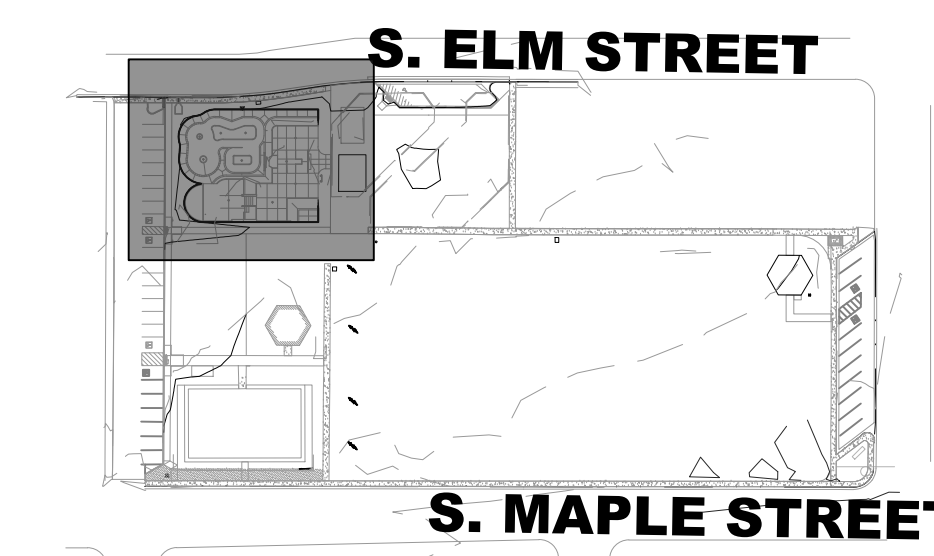

KEY MAP
SCALE: 1" = 150'

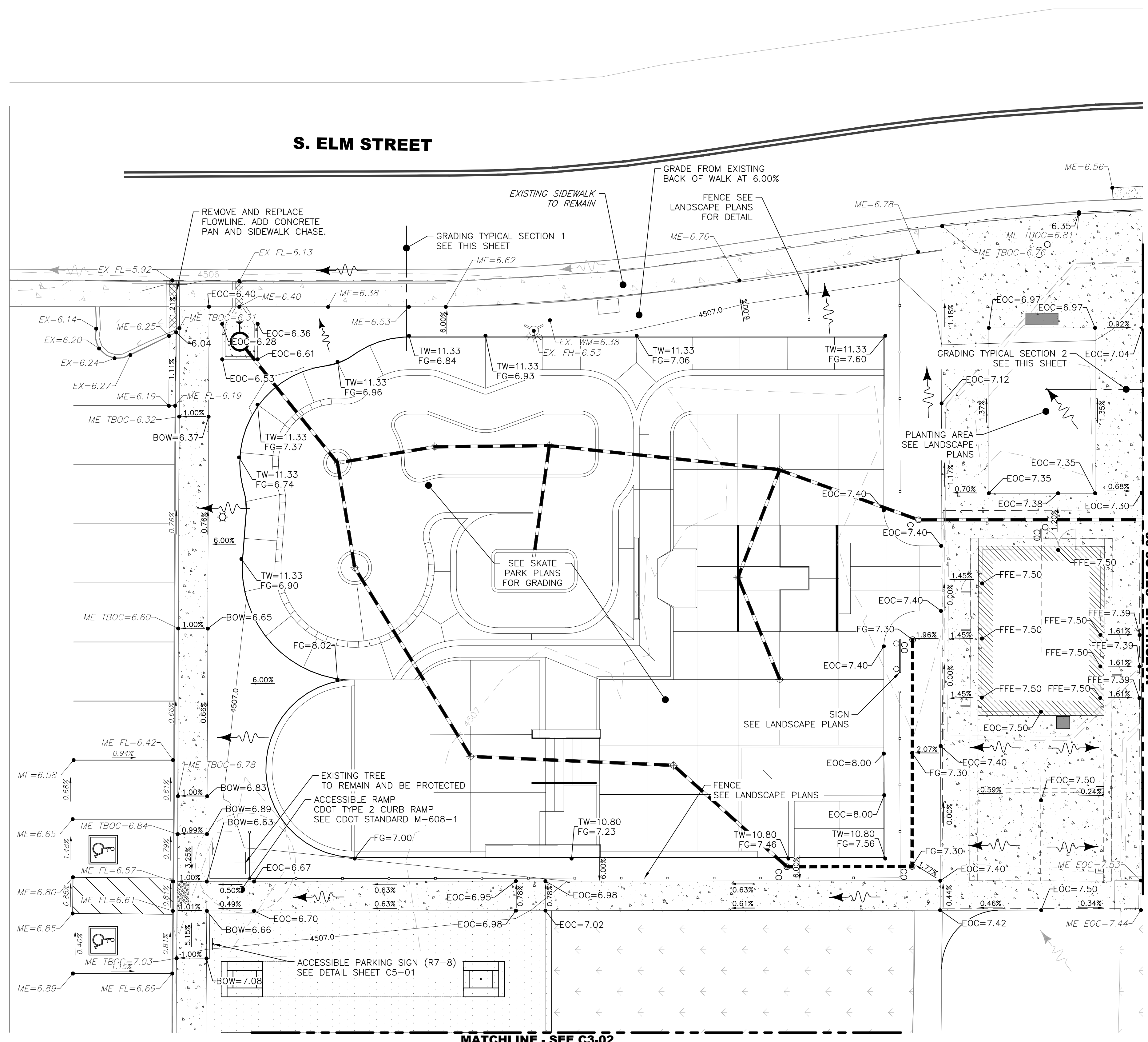
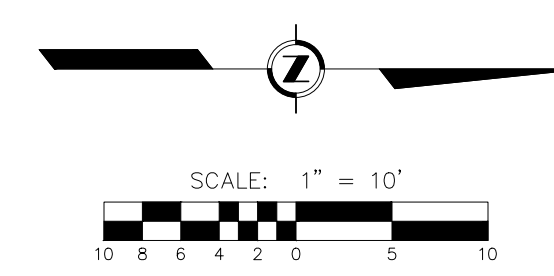

EXISTING	LEGEND	PROPOSED
	CURB & GUTTER	
	SPILL CURB & GUTTER	
	BUILDINGS	
	ASPHALT	
	PEDESTRIAN-RATED CONCRETE	
	GRAVEL/CRUSHER FINES	
	VEHICULAR-RATED CONCRETE	
	MULCH SURFACING	
	CONTOURS	
	SPOT GRADE	
	FLOW ARROW	
	STORM SEWER	
	PERFORATED UNDERDRAIN	
	CLEANOUT	

SPOT ELEVATION STANDARD ABBREVIATIONS

BOW - BACK OF WALK
EX - EXISTING
FF - FINISHED FLOOR
FG - FINISHED GRADE
HP - HIGH POINT
LP - LOW POINT
ME - MATCH EXISTING
TBOC - TOP BACK OF CURB
TW - TOP OF WALL

NOTES:
ASSUME SPOT ELEVATION REPRESENTS "FLOW LINE" ELEVATION UNLESS OTHERWISE NOTED.
TOP OF WALL ELEVATIONS PER SKATEPARK PLANS
OVERALL SPOT ELEVATIONS ARE SHORTHAND FOR 4500. I.E. 53.50' IS 4553.50'

REED PARK IMPROVEMENTS
FRUITA, CO



ISSUE DATE: JUNE 15, 2023

REVISIONS	DATE	DESCRIPTION
1	08/03/23	CD REVISION 1

DRAWN: KA REVIEWED: BM

PERMIT SET

PROJECT NUMBER: 6961

DETAILED GRADING PLAN 1

SHEET NUMBER

C3-01

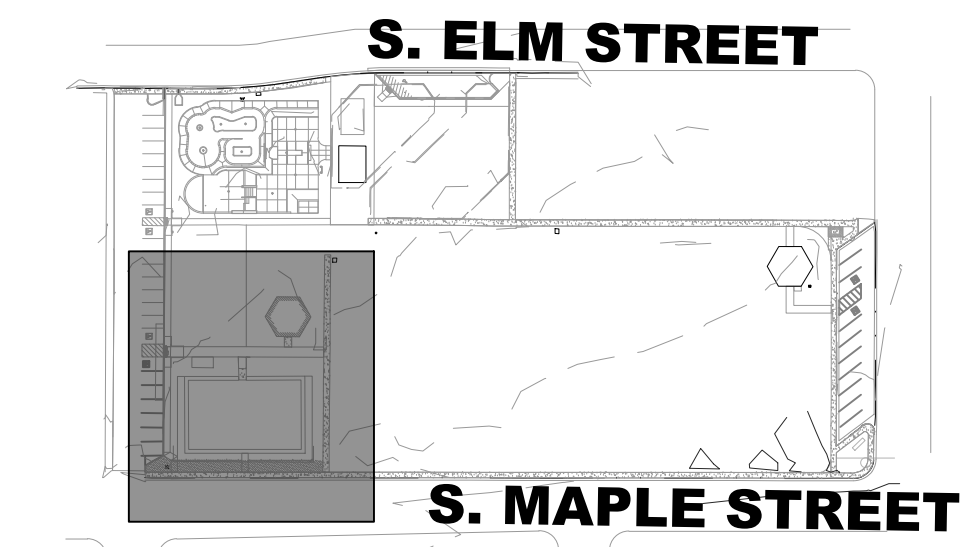

KEY MAP
SCALE: 1" = 150'

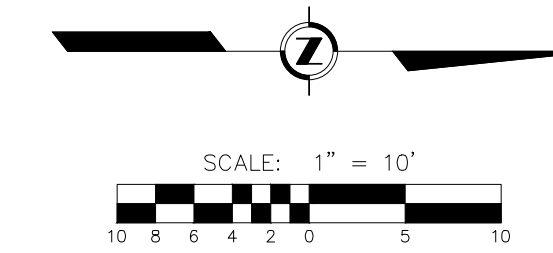

EXISTING	LEGEND	PROPOSED
	CURB & GUTTER	
	SPILL CURB & GUTTER	
	BUILDINGS	
	ASPHALT	
	PEDESTRIAN-RATED CONCRETE	
	GRAVEL/CRUSHER FINES	
	VEHICULAR-RATED CONCRETE	
	MULCH SURFACING	
	CONTOURS	
	SPOT GRADE	
	FLOW ARROW	
	STORM SEWER	
	PERFORATED UNDERDRAIN	
	CLEANOUT	

SPOT ELEVATION STANDARD ABBREVIATIONS

- BOW - BACK OF WALK
- EX - EXISTING
- FF - FINISHED FLOOR
- FG - FINISHED GRADE
- HP - HIGH POINT
- LP - LOW POINT
- ME - MATCH EXISTING
- TBOC - TOP BACK OF CURB
- TW - TOP OF WALL

NOTES:
ASSUME SPOT ELEVATION REPRESENTS "FLOW LINE" ELEVATION UNLESS OTHERWISE NOTED.
TOP OF WALL ELEVATIONS PER SKATEPARK PLANS
OVERALL SPOT ELEVATIONS ARE SHORTHAND FOR 4500. I.E. 53.50' IS 4553.50'

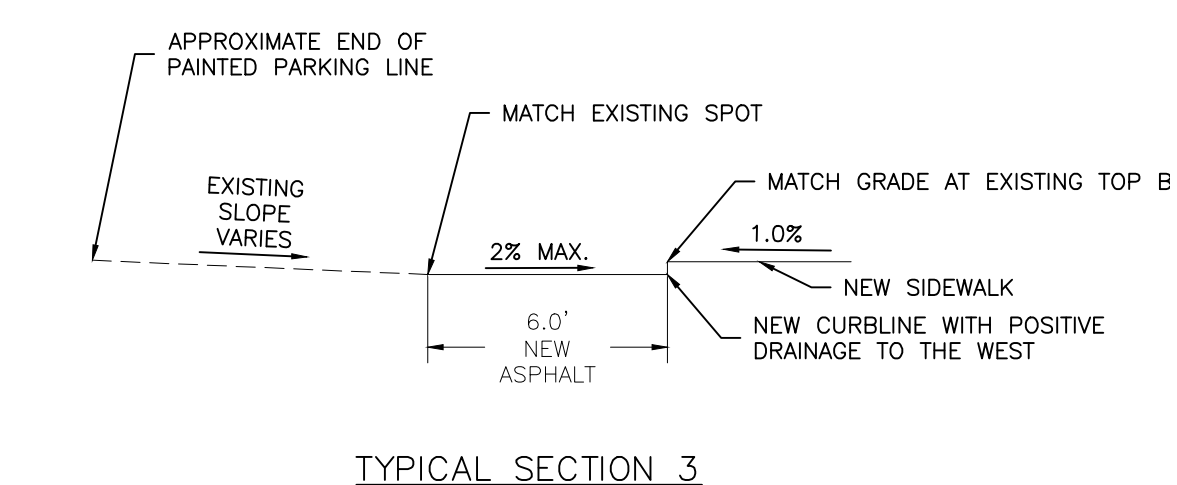
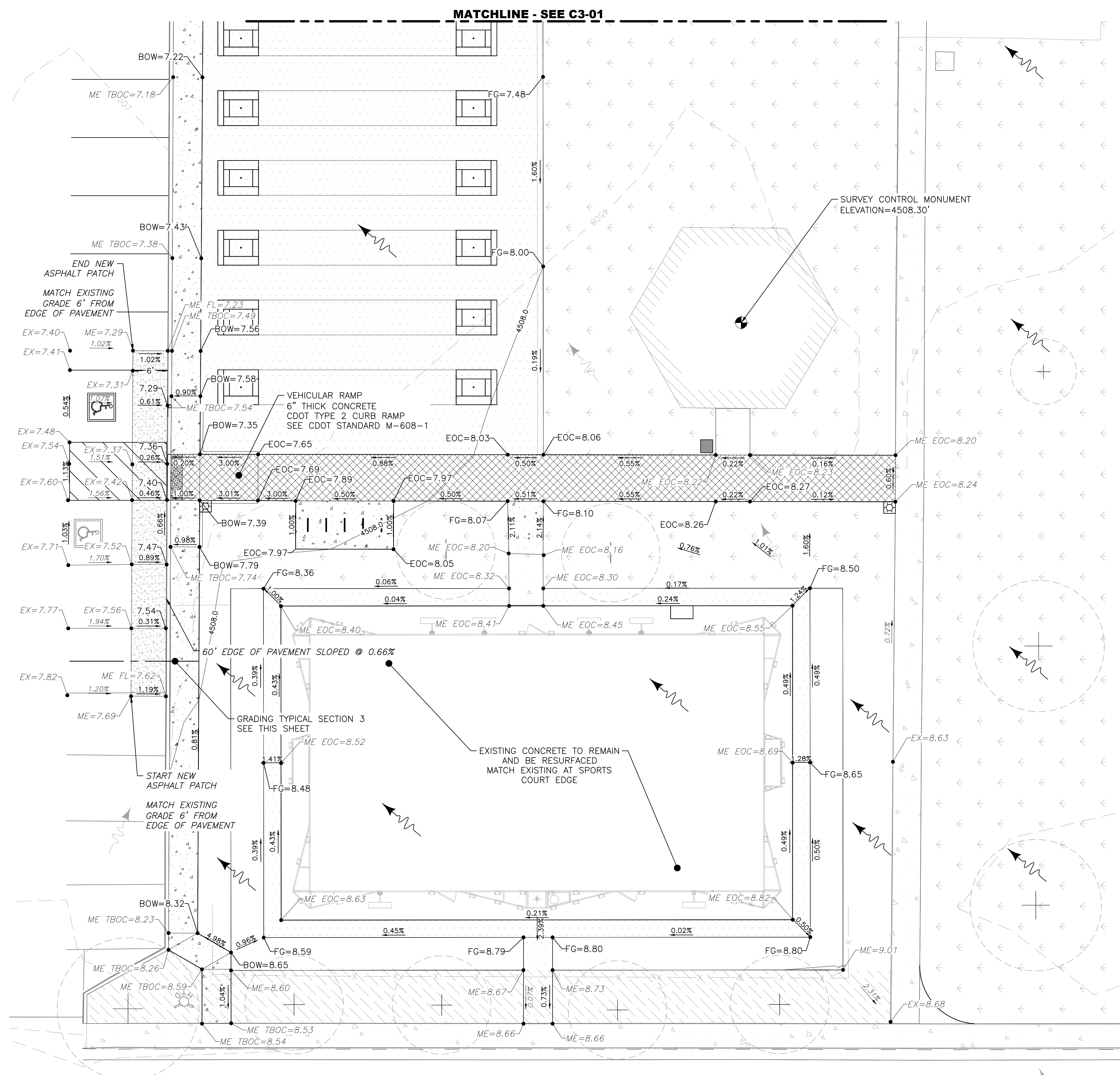

TYPICAL SECTION 3

REED PARK
IMPROVEMENTS
FRUITA, CO



ISSUE DATE: JUNE 15, 2023

REVISIONS	DATE	DESCRIPTION
1	08/03/23	CD REVISION 1

DRAWN: KA REVIEWED: BM

PERMIT SET

PROJECT NUMBER: 6961

DETAILED
GRADING PLAN 2

SHEET NUMBER

C3-02

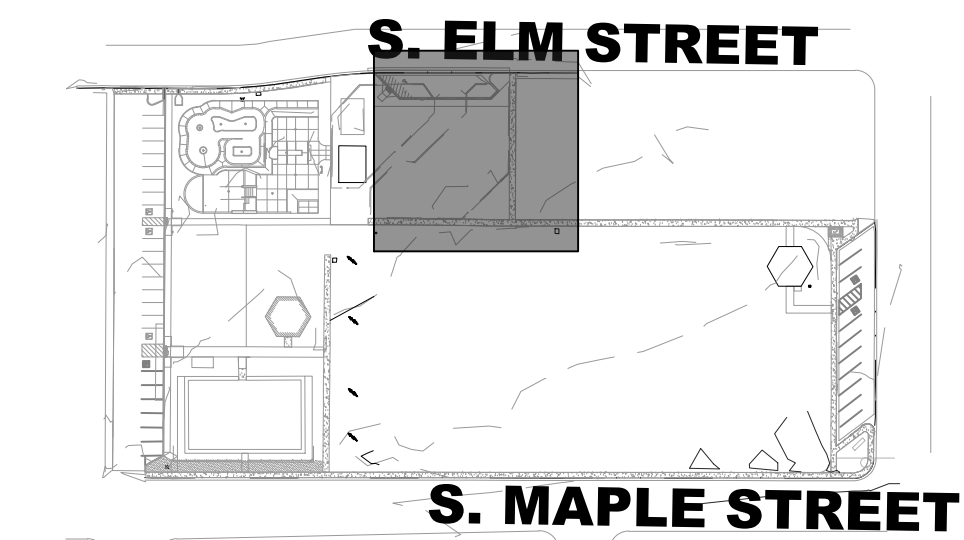

KEY MAP
SCALE: 1" = 150'

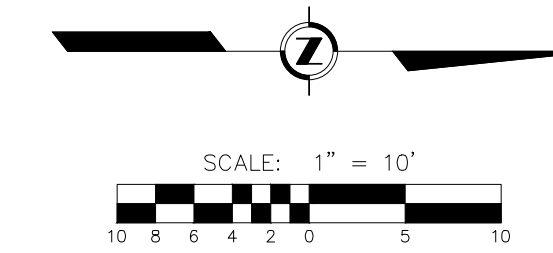

EXISTING	LEGEND	PROPOSED
	CURB & GUTTER	
	SPILL CURB & GUTTER	
	BUILDINGS	
	ASPHALT	
	PEDESTRIAN-RATED CONCRETE	
	GRAVEL/CRUSHER FINES	
	VEHICULAR-RATED CONCRETE	
	MULCH SURFACING	
	CONTOURS	
	SPOT GRADE	
	FLOW ARROW	
	STORM SEWER	
	PERFORATED UNDERDRAIN	
	CLEANOUT	

SPOT ELEVATION STANDARD ABBREVIATIONS

- BOW - BACK OF WALK
- EX - EXISTING
- FF - FINISHED FLOOR
- FG - FINISHED GRADE
- HP - HIGH POINT
- LP - LOW POINT
- ME - MATCH EXISTING
- TBOC - TOP BACK OF CURB
- TW - TOP OF WALL

NOTES:
ASSUME SPOT ELEVATION REPRESENTS "FLOW LINE" ELEVATION UNLESS OTHERWISE NOTED.
TOP OF WALL ELEVATIONS PER SKATEPARK PLANS
OVERALL SPOT ELEVATIONS ARE SHORTHAND FOR 4500. I.E. 53.50' IS 4553.50'

DRAINAGE NOTES:

UNDER DRAIN IN ENGINEERED WOOD FIBER:
INSTALL EQUIPMENT FOUNDATIONS AND PIP SURFACING BEFORE INSTALLING UNDERDRAIN IN ENGINEERED WOOD FIBER. CENTER OF UNDER DRAIN PIPE SHOULD BE 3' FROM EDGE OF EQUIPMENT FOUNDATION

REED PARK IMPROVEMENTS
FRUITA, CO



ISSUE DATE: JUNE 15, 2023

REVISIONS	DATE	DESCRIPTION
1	08/03/23	CD REVISION 1

DRAWN: KA REVIEWED: BM

PERMIT SET

PROJECT NUMBER: 6961

DETAILED GRADING PLAN 3

SHEET NUMBER

C3-03

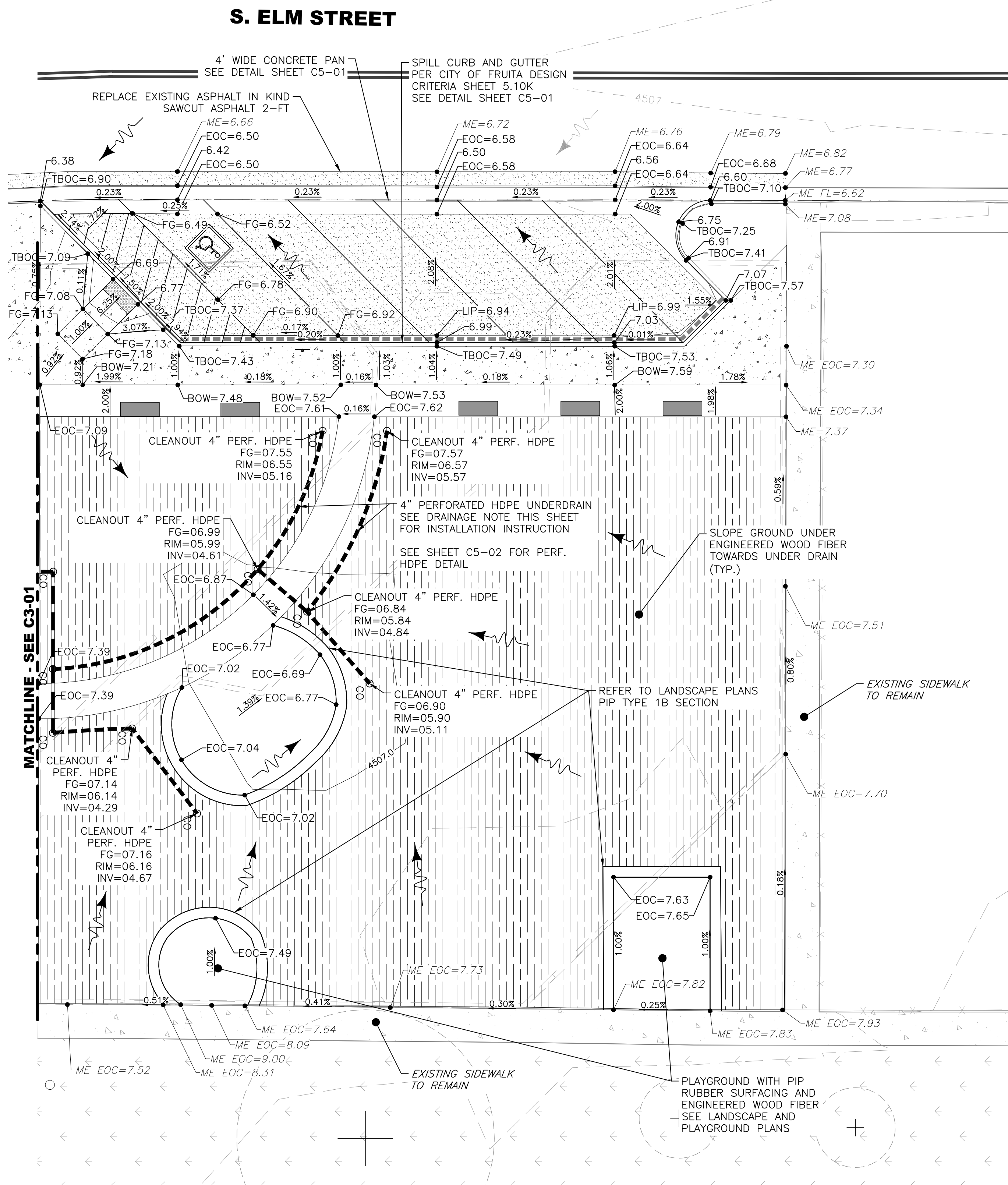

**REED PARK
 IMPROVEMENTS**
 FRUITA, CO



ISSUE DATE: JUNE 15, 2023

REVISIONS

1	08/03/23	CD REVISION 1
---	----------	---------------

DRAWN: KA REVIEWED: BM

PERMIT SET

PROJECT NUMBER: 6961

DETAILED
 GRADING PLAN 4

SHEET NUMBER

C3-04

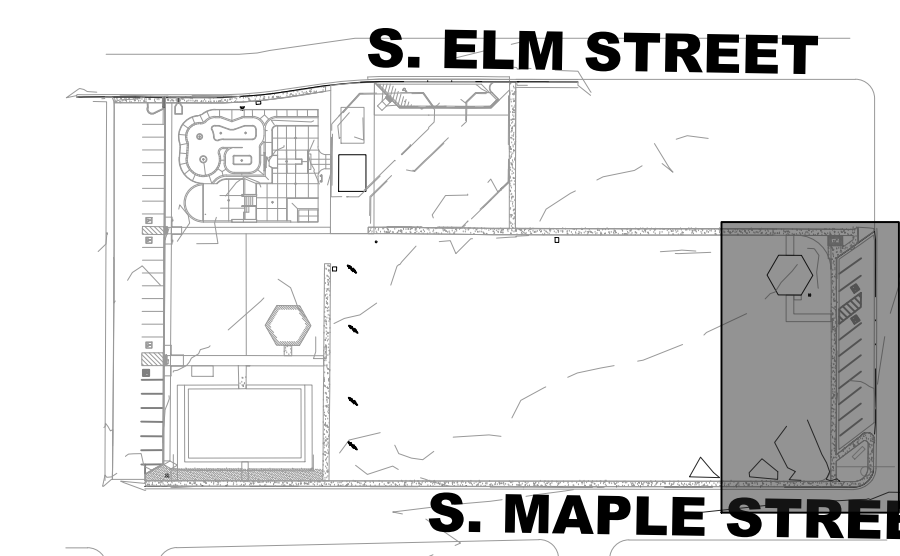

KEY MAP
 SCALE: 1" = 150'

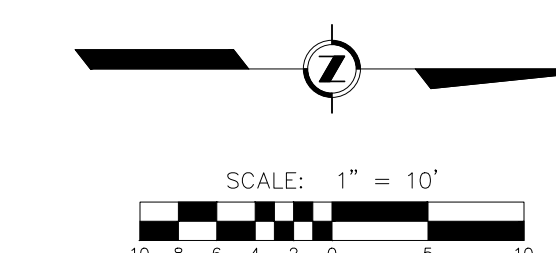

EXISTING	LEGEND	PROPOSED
	CURB & GUTTER	
	SPILL CURB & GUTTER	
	BUILDINGS	
	ASPAHLT	
	PEDESTRIAN-RATED CONCRETE	
	GRAVEL/GRUSHER FINES	
	VEHICULAR-RATED CONCRETE	
	MULCH SURFACING	
	CONTOURS	
	SPOT GRADE	
	FLOW ARROW	
	STORM SEWER	
	PERFORATED UNDERDRAIN	
	CLEANOUT	

SPOT ELEVATION STANDARD ABBREVIATIONS

- BOW - BACK OF WALK
- EX - EXISTING
- FF - FINISHED FLOOR
- FG - FINISHED GRADE
- HP - HIGH POINT
- LP - LOW POINT
- ME - MATCH EXISTING
- TBOC - TOP BACK OF CURB
- TW - TOP OF WALL

NOTES:
 ASSUME SPOT ELEVATION REPRESENTS "FLOW LINE"
 ELEVATION UNLESS OTHERWISE NOTED.

TOP OF WALL ELEVATIONS PER SKATEPARK PLANS
 OVERALL SPOT ELEVATIONS ARE SHORTHAND FOR 4500.
 I.E. 53.50' IS 4553.50'

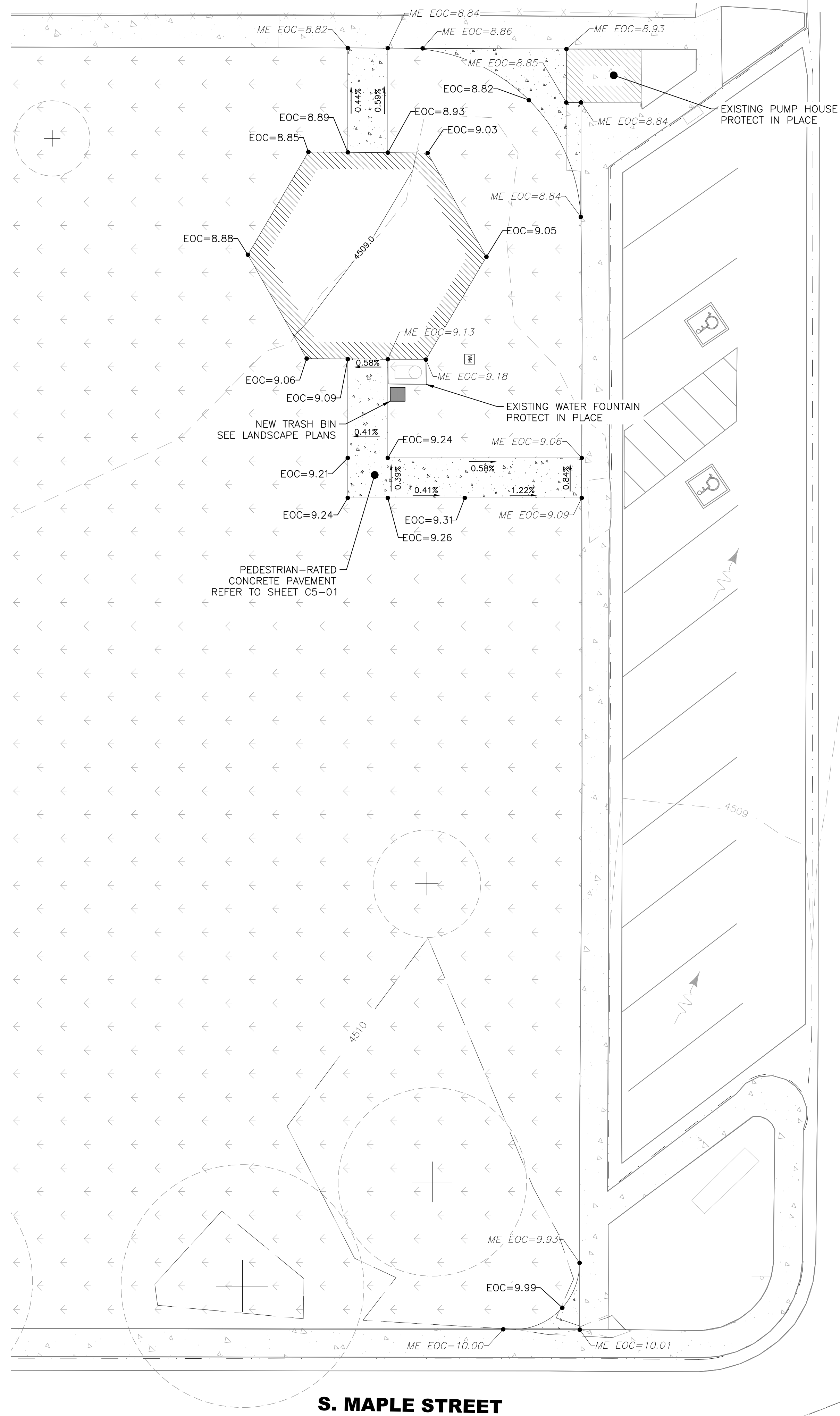

S. MAPLE STREET

LEGEND

EXISTING	PROPOSED
CURB & GUTTER	CURB & GUTTER
SPILL CURB & GUTTER	SPILL CURB & GUTTER
BUILDINGS	BUILDINGS
ASPAHLT	ASPAHLT
PEDESTRIAN-RATED CONCRETE	PEDESTRIAN-RATED CONCRETE
GRAVEL / CRUSHER FINES	GRAVEL / CRUSHER FINES
VEHICULAR-RATED CONCRETE	VEHICULAR-RATED CONCRETE
MULCH SURFACING	MULCH SURFACING
CONTOURS	CONTOURS
SPOT GRADE	SPOT GRADE
FLOW ARROW	FLOW ARROW

SPOT ELEVATION STANDARD ABBREVIATIONS

BOW	-BACK OF WALK
EX	-EXISTING
FF	-FINISHED FLOOR
FG	-FINISHED GRADE
HP	-HIGH POINT
LP	-LOW POINT
ME	-MATCH EXISTING
TBOC	-TOP BACK OF CURB

NOTE: ASSUME SPOT ELEVATION REPRESENTS "FLOW LINE" ELEVATION UNLESS OTHERWISE NOTED.

OVERALL SPOT ELEVATIONS ARE SHORTHAND FOR 4500.
I.E. 53.50' IS 4553.50'

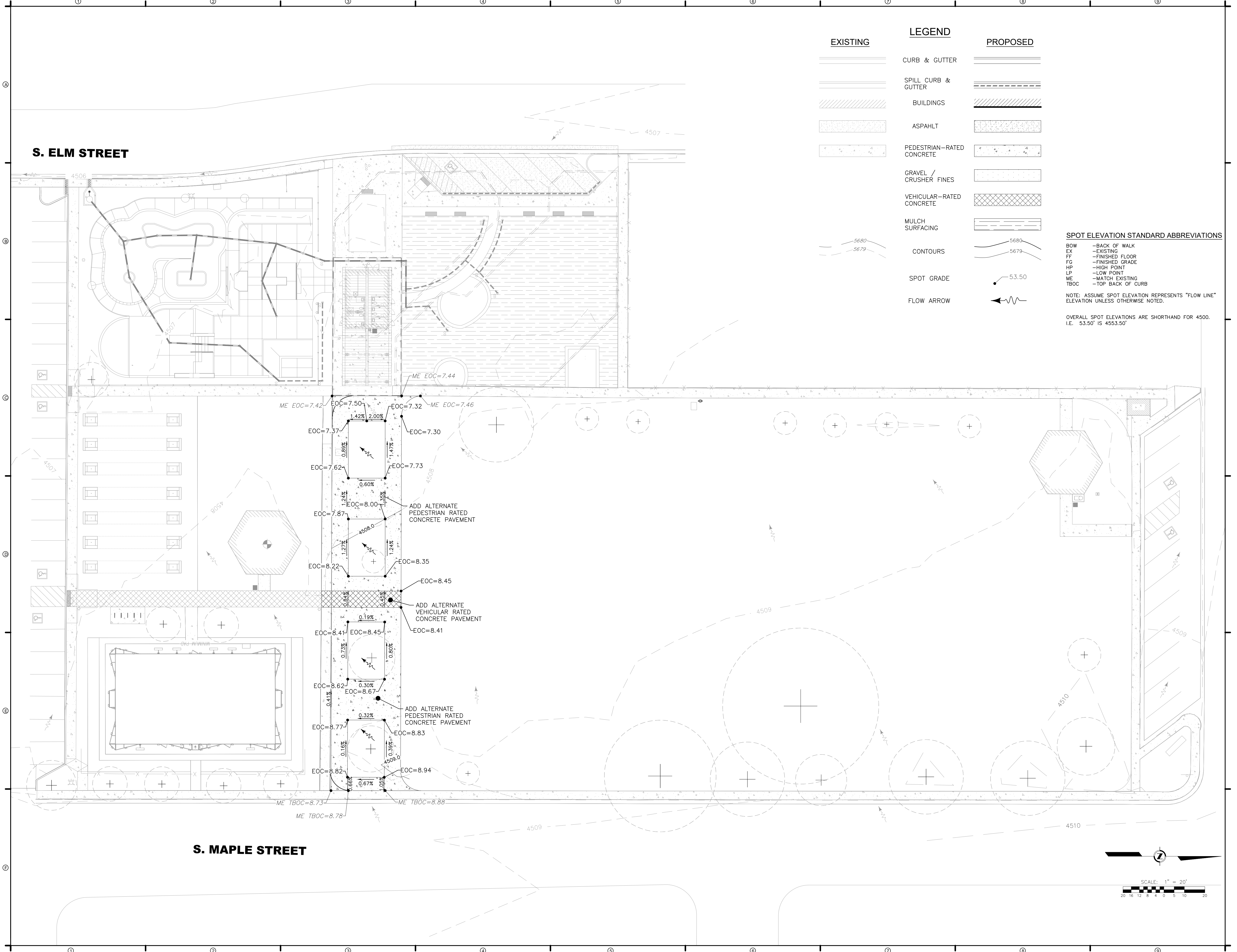

REED PARK IMPROVEMENTS
FRUITA, CO



ISSUE DATE: JUNE 15, 2023

REVISIONS

1	08/03/23	CD REVISION 1
---	----------	---------------

DRAWN: KA REVIEWED: BM

PERMIT SET

PROJECT NUMBER: 6961

ADD ALTERNATE - SITE & GRADING PLAN

SHEET NUMBER

C3-05

REED PARK
IMPROVEMENTS
FRUITA, CO



ISSUE DATE: JUNE 15, 2023

NO.	DATE	REVISION
1	08/03/23	CD REVISION 1

DRAWN: KA REVIEWED: BM

PERMIT SET

PROJECT NUMBER: 6961

SUBMERSIBLE
STORM PUMP
PLAN

SHEET NUMBER

C4-00

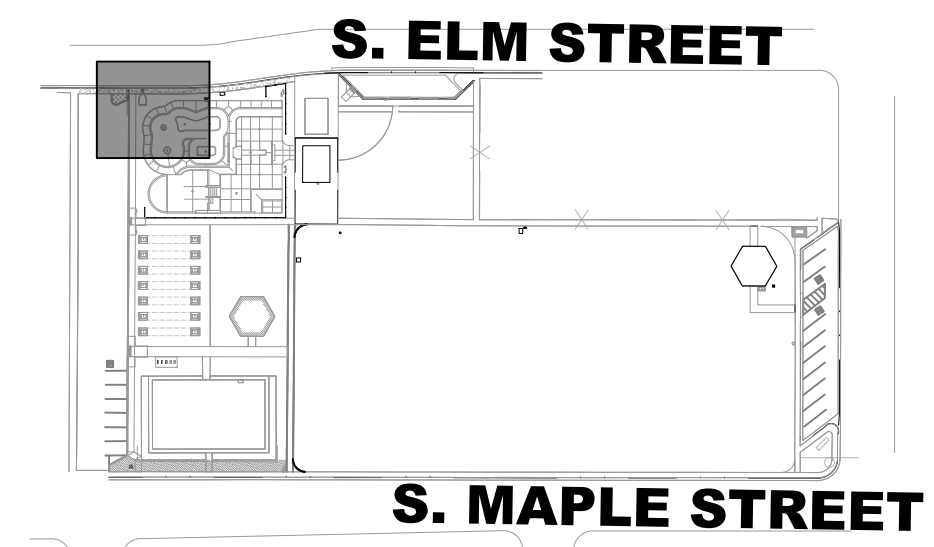
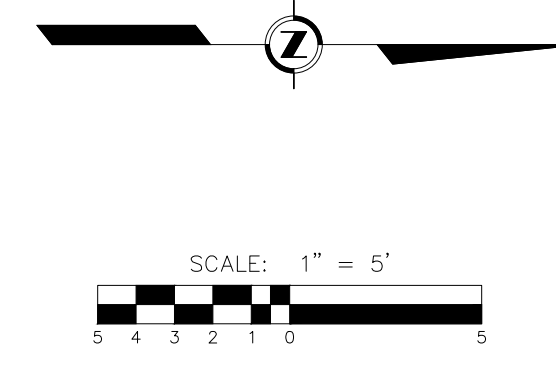

KEY MAP
SCALE: 1" = 150'

EXISTING	LEGEND	PROPOSED
	CURB & GUTTER	
	SPILL CURB & GUTTER	
	BUILDINGS	
	ASPAHLT	
	PEDESTRIAN-RATED CONCRETE	
	VEHICULAR-RATED CONCRETE	
	GRAVEL/CRUSHER FINES	
	MULCH SURFACING	
	CONTOURS	
	SPOT GRADE	
	FLOW ARROW	

SPOT ELEVATION STANDARD ABBREVIATIONS

- BOW - BACK OF WALK
- EX - EXISTING
- FF - FINISHED FLOOR
- FG - FINISHED GRADE
- HP - HIGH POINT
- LP - LOW POINT
- ME - MATCH EXISTING
- TBOC - TOP BACK OF CURB
- TW - TOP OF WALL

NOTES:
ASSUME SPOT ELEVATION REPRESENTS "FLOW LINE" ELEVATION UNLESS OTHERWISE NOTED.

TOP OF WALL ELEVATIONS PER SKATEPARK PLANS

OVERALL SPOT ELEVATIONS ARE SHORTHAND FOR 4500. I.E. 53.50' IS 4553.50'

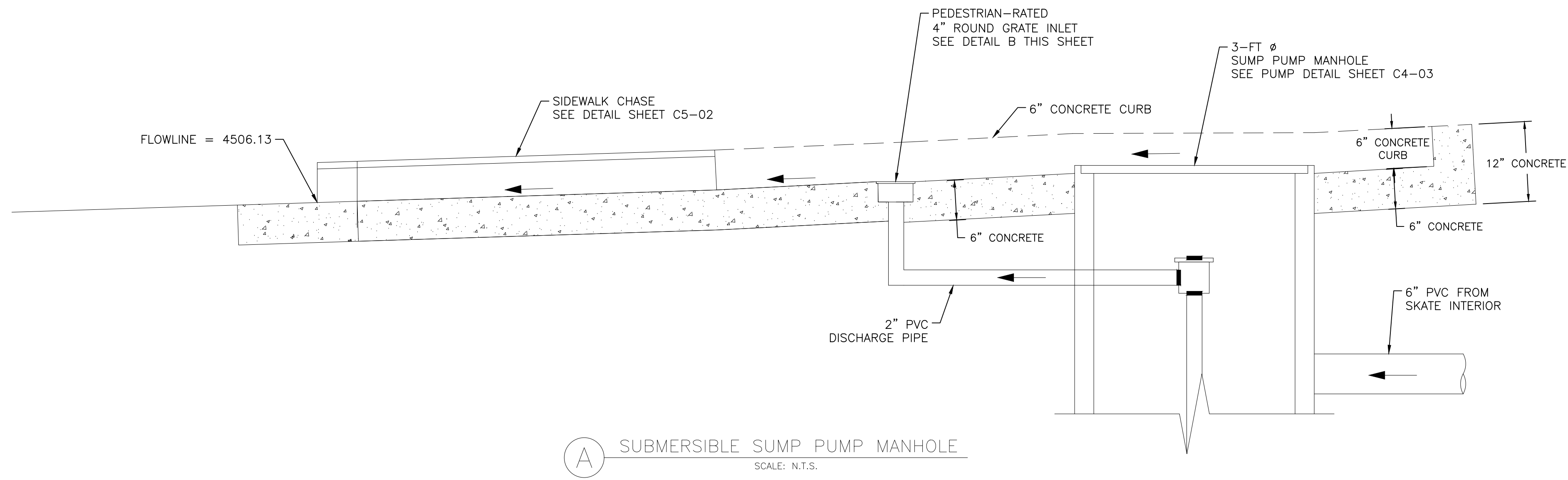
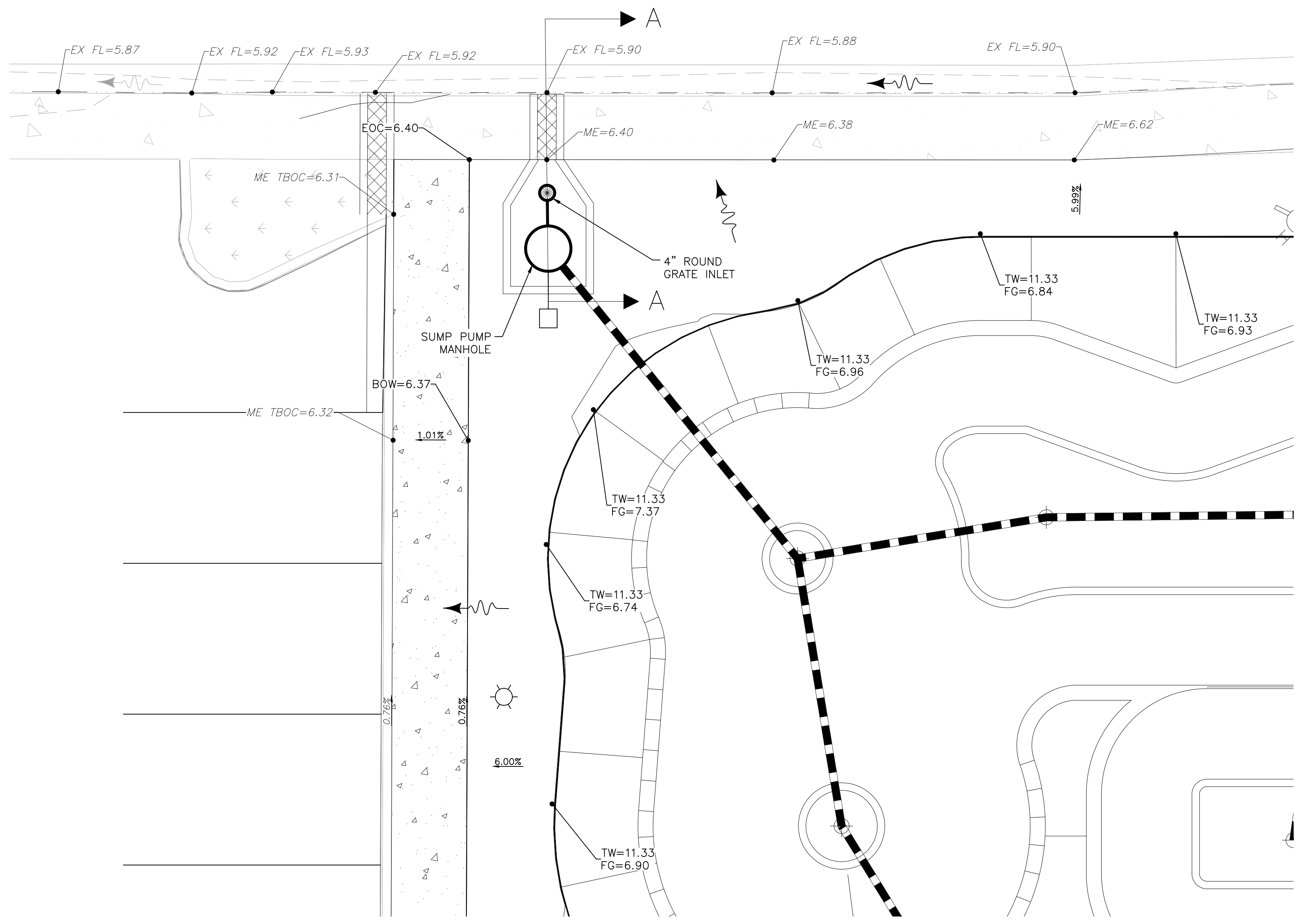

A SUBMERSIBLE SUMP PUMP MANHOLE
SCALE: N.T.S.

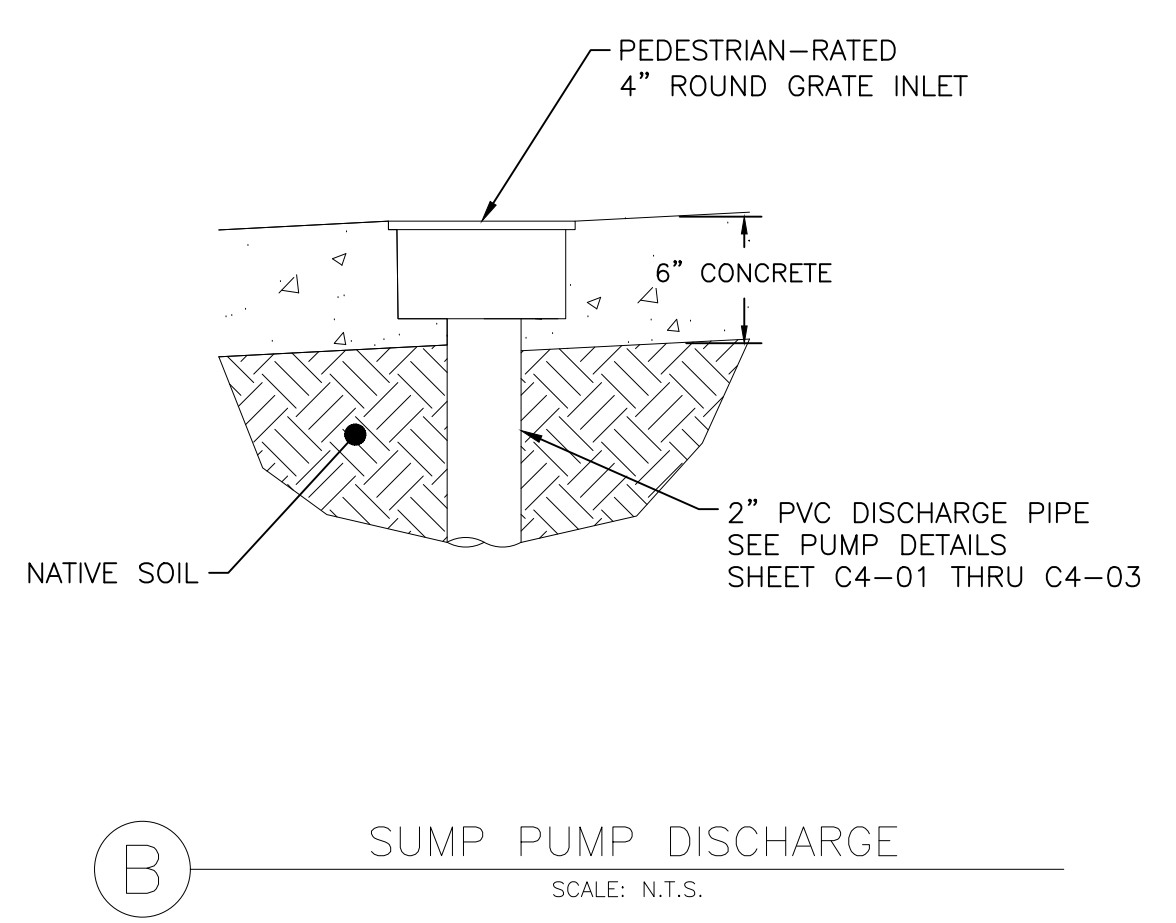

B SUMP PUMP DISCHARGE
SCALE: N.T.S.

NOTE: CUT SHEETS SHOWN HEREON ARE BASIS OF DESIGN, APPROVED EQUAL ALTERNATES ARE ACCEPTABLE.

WEIL 2-Inch Submersible Wastewater Pump 2413

Heavy duty pump for residential and commercial applications. Pump clear water, gray water, effluent and wastewater with solids up to 2 inch diameter.
Pump
 Case - Cast Iron
 Impeller - Cast Iron
 Mounting Style 2613 Removal

Disch. Size 2 Inch
 Disch. Type ANSI
 Solids Max. 2 Inch

- Motor**
Single Seal
 - Carbon against Ceramic
Air-Filled Hermetically Sealed Shaft - Stainless Steel Series 300
 Motor Shell - Cast Iron
 Insulation - Class F
Ball Bearings - 2 - Double Sealed
Three-phase motor
 - 1750 RPM
 - 60 Hz, 208-230 or 460 volts
 - Power Cable Length - 15 ft.
Single-phase capacitor start motor
 - 1750 RPM,
 - 60 Hz, 115 volts
 - Power Cable Length - 15 ft. with 3 conductor grounded plug
 - Automatic reset thermal and overload protection

Capacities - Wet Wells		
Dia or Side Inches	Gallons per Foot of Depth	
	Round	Square
18	13	17
24	24	30
30	37	47
36	53	67
48	94	120
60	147	187
72	212	269

Flow - To prevent solids from settling out		
Discharge Pipe Size Dia Inches	Minimum Flow GPM	Flow GPM
1 1/2	15	
2	25	
3	50	

Good wet well design
 Maximum 10 starts per hour.
 Minimum run time - 1 1/2 minutes.

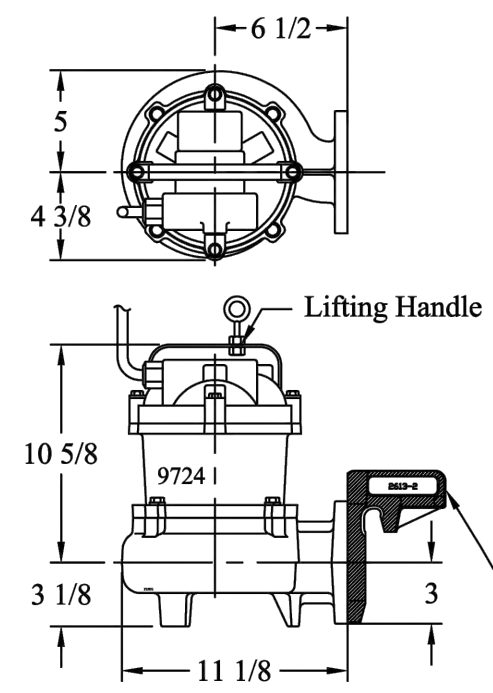

PUMP CURVE NEXT PAGE

How To Order: Specify Model Number, Phase and Volts

Replaces SN-2413, Aug 1, 2011 SN-2413 JULY 1, 2015 2413

WEIL 2 Inch Removal System 2613-2

April 9, 2018

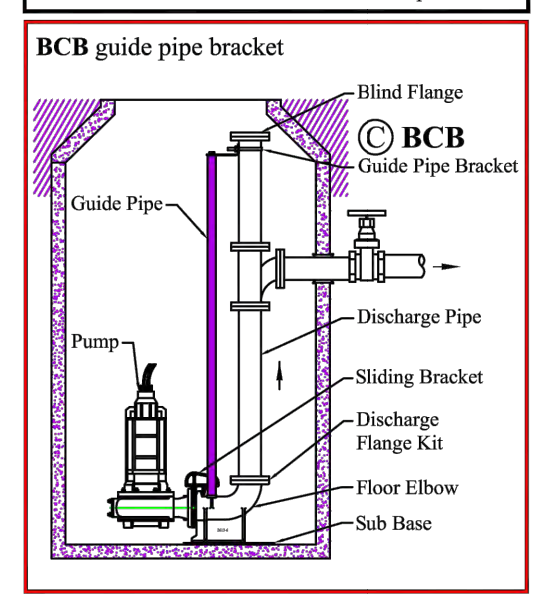
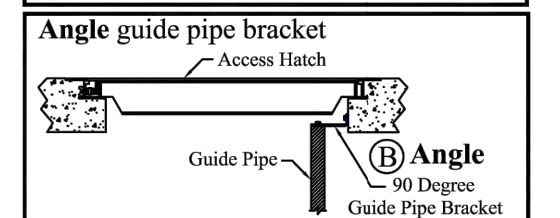
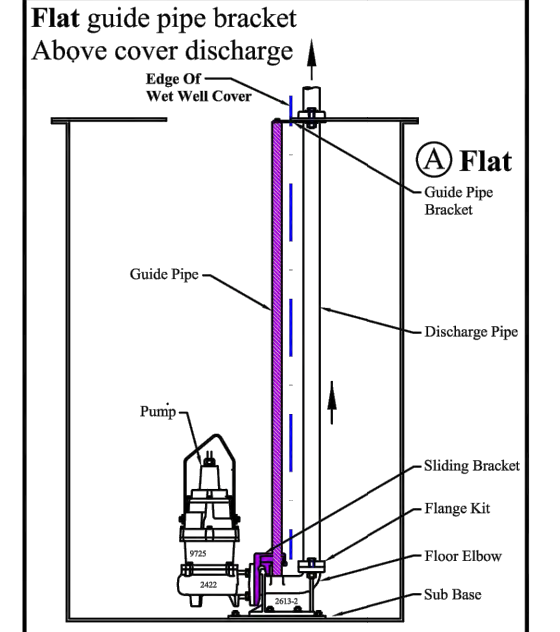

Discharge Flange Kit - For Floor Elbow
 Includes - Flange, Gasket and Hardware
 Well = 2 bolt oval configuration

Order Number	Material	Pipe Type	Flange Type
2613K102	Cast Iron	Threaded	Well
2613K202	Cast Iron	Plain End	Well
2613K942	316 SS	Plain End	Well

Intermediate Guide Pipe Bracket:
 205.666.002 Intermediate Guide Pipe Bracket

www.weilpump.com SN-2613-2 Page 1

- System Includes:**
 • Discharge Floor Elbow - one
 • Sliding Bracket - one
 - Iron or Bronze for use with Explosion Proof Motors
 - 316 Stainless Steel
 • Guide Pipe Bracket - one
 - Flat (cover mount) - bolts to wet well cover or
 - Angle 90° (side mount) bolts to vertical side wall or
 - BCB Bracket - mounts to discharge pipe

Not Included:
 • Discharge Pipe - (2 inch schedule 40), Guide Pipe - (1 inch schedule 40)

- Options:**
 • Discharge Flange Kit for Floor Elbow
 • Intermediate Guide Pipe Bracket
 • Sub Base for Floor Elbow
 • Level Control Lifting Assembly for BCB Duplex Bracket

Removal System:

Simplex						
Order Number	Floor Elbow	Sliding Bracket	Guide Pipe Bracket	Mount Type	Weight Lbs.	
2613K1021	Iron	Iron	Flat	Cover	42	
2613K2021	Iron	Bronze	Flat	Cover	42	
2613K9102	316 SS	316 SS	Flat	Cover	42	
2613K5013	Iron	Iron	Angle	Side	42	
2613K6032	Iron	Bronze	Angle	Side	42	
2613K9122	316 SS	316 SS	Angle	Side	42	
2613K3021	Iron	Iron	BCB	Pipe	42	
2613K4021	Iron	Bronze	BCB	Pipe	42	
2613K9132	316 SS	316 SS	BCB	Pipe	42	

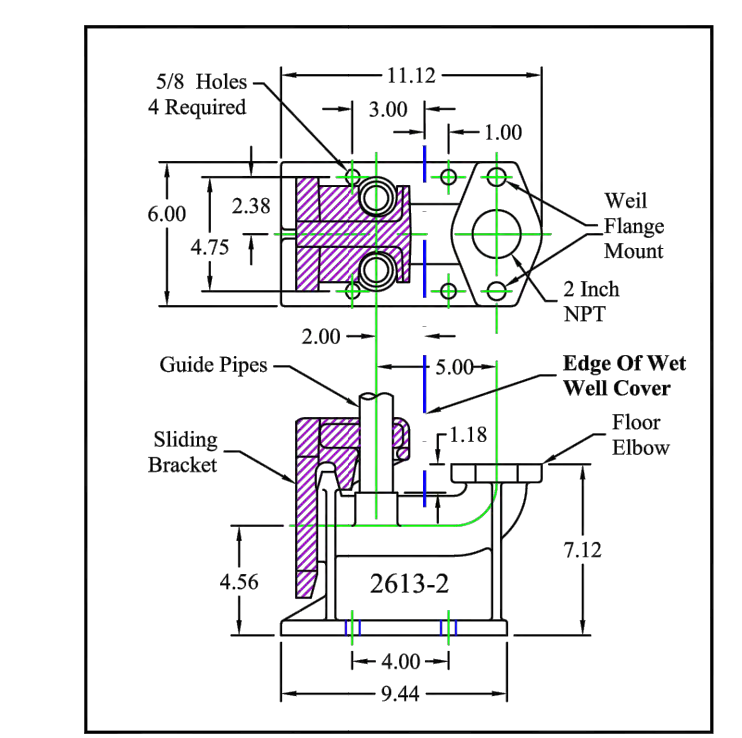

www.weilpump.com SN-2613-2 Page 1 Repl. March 23, 2017 2613-2

WEIL 2 Inch Removal System 2613-2

April 9, 2018

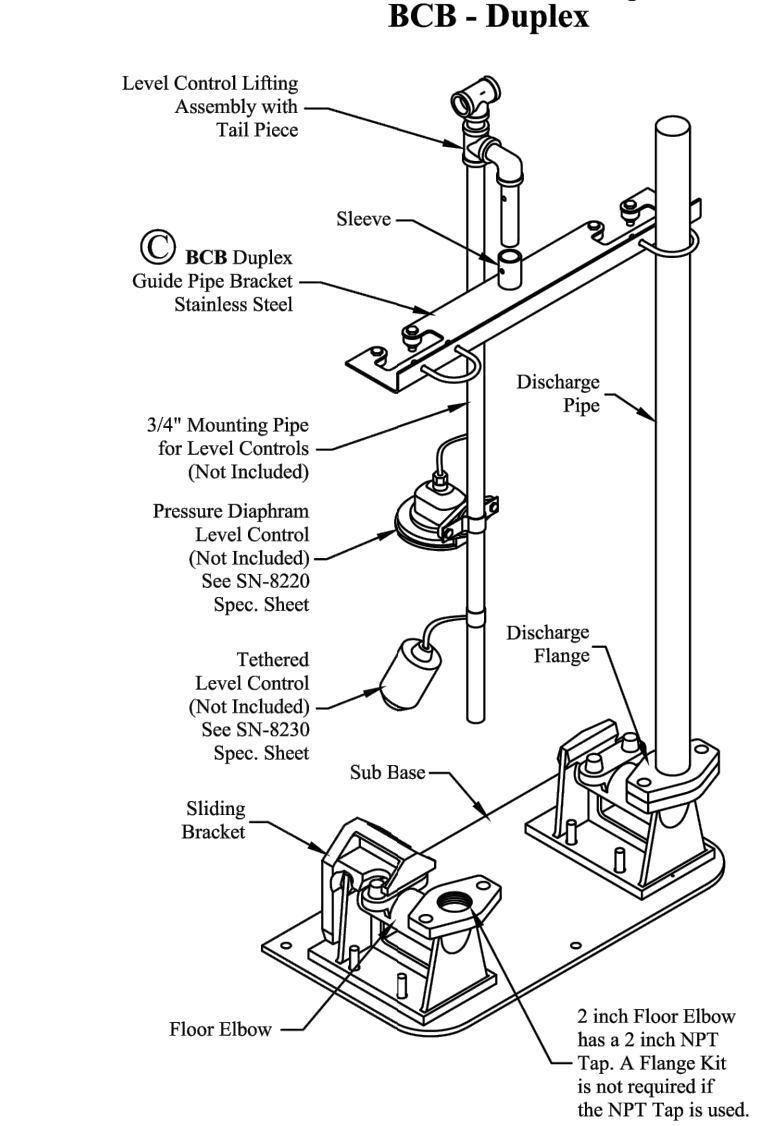
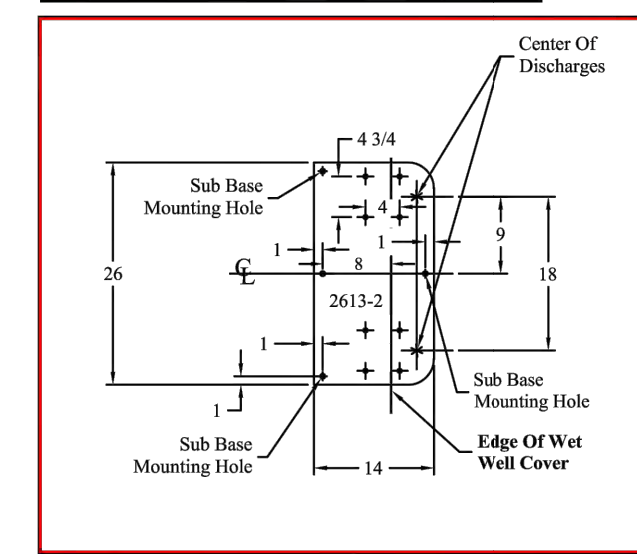
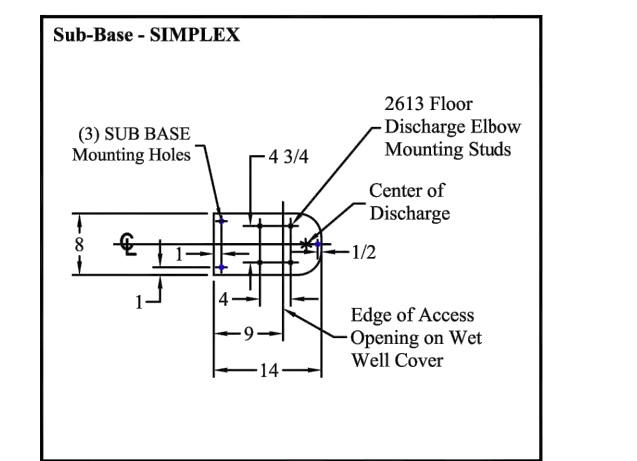
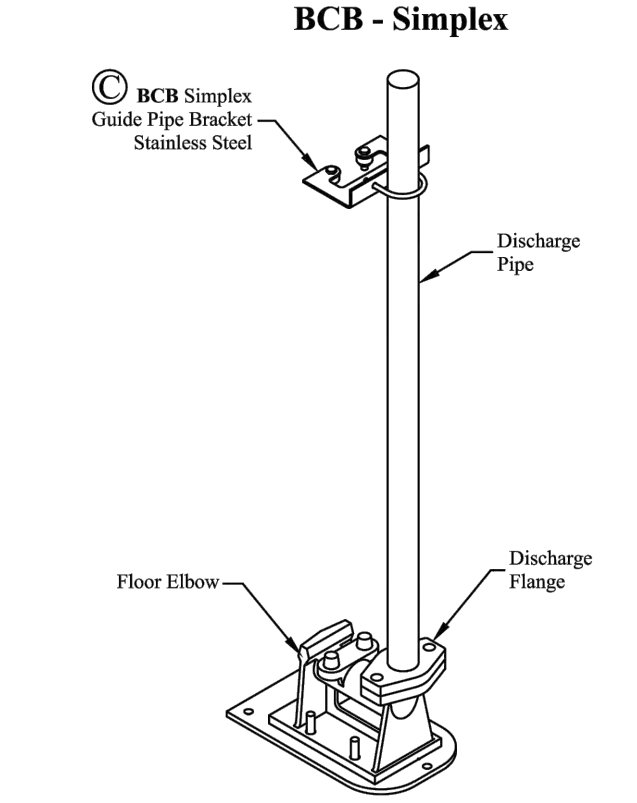

Sub Base for Duplex Installations
 Steel Galvanized or Stainless Steel sub base with stainless steel studs is used to locate and install the 2613 discharge floor elbows in a wet well. Mounting locations match standard Weil 8804/8815 wet well covers and 2616 valves. Three 9/16 holes for bolting to the wet well floor. Waterproof adhesive 3M Marine 5200 could be used instead of bolting.

Order Number	Style	Material	Stud Size	Min. Wet Well Diameter
2613K602	Simplex	Galvanized	1/2"	24"
2613K922	Simplex	304 SS	1/2"	24"
2613K501	Duplex	Galvanized	1/2"	36"
2613K902	Duplex	304 SS	1/2"	36"

Level Control Lifting Assembly
 (Duplex BCB systems only)
 Does not include level control switches or mounting pipe.
 See SN-8230 and SN-8230

Order Number	Level Control Lifting Assembly with Tailpiece
2613K801	Level Control Lifting Assembly with Tailpiece

www.weilpump.com SN-2613-2 Page 2 Repl. March 23, 2017 2613-2

WEIL Duplex Alternating Pump Control Panel 8136

Single or Three Phase - Type 4X Enclosure - U/L Label
 Tamper-Proof Design - Motor Overload Protection

- The 8136 Duplex Panel controls two pumps. It is a full featured panel that has motor overload protection and includes two power to pump lights, control power light, and high water alarm system.
- The Type 4X Poly enclosure provides protection against falling dirt, rain, sleet, snow, wind blown dust, splashing water, hose directed water and corrosion. Can be used where type 1, 3, 3R, 4, 4X and 12 enclosures are specified.
- Panel can be operated on 50 or 60 Hertz power.
- Select level controls separately
 - 8213 Mechanical Lever switch.
 - 8220 Pressure Diaphragm switch.
 - 8230 Tethered switch.

- Panel Includes:**
- U/L listed label and padlocking hasp.
 - LED Lights are mounted on door. Switches are mounted on inside of panel.
 - Two lockable pump disconnects on motor overload protectors. Lock is not provided.
 - Two Contactors - Industrial Duty.
 - Two Overloads - Ambient compensated bi-metallic (Class 10) motor overloads circuit protector. Instantaneous magnetic trip for short circuit protection. Single-phase protection for three phase motors. Field adjustable within the amp range.
 - Electric Alternator has a 3 position selector switch: that locks the pumps in Auto, Pump 1-2 or Pump 2-1 sequencing.
 - Control Transformer with fused primary for single phase 208 and 230 volt and three phase 208-230/460 volt. Single phase 115 volt has a fused control circuit.
 - Pump run switches - three position TOA (Test Off Automatic) with spring return from test position.
 - Green LED lights indicates power to pump motors.
 - White LED lights indicates control power on.
 - Pump Run Status Isolated Contacts.
 - Pump Overload Isolated Contacts.
 - High Water Alarm System. Hold the finger over hole of horn for 1-2 seconds and remove to silence horn (95dB).
 - Alarm test button inside panel.
 - Two isolated contact for remote monitoring.
 - Control terminal board, numbered and wired.
 - Layout and schematic CAD diagrams are provided. Installer connections at terminal board are clearly marked.

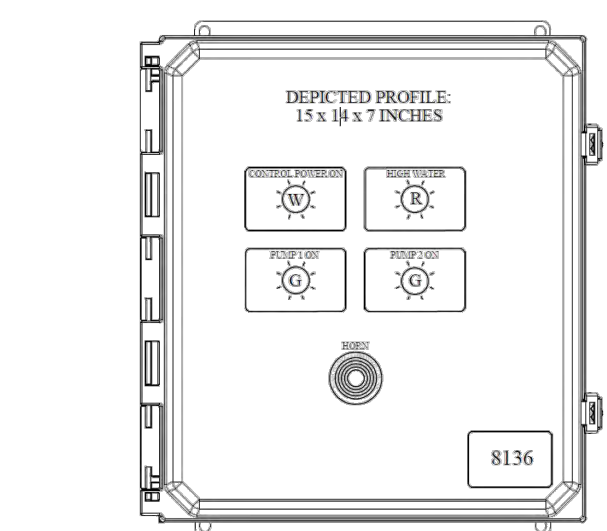

Motor Protector Amp Range	Single-Phase 115 Volts	Three-Phase 208 or 230 Volts	Approx. Weight Lbs.
1.0 - 1.6	8136-L-016	8136-D-016	8136-L016 20
1.6 - 2.5	8136-L-025	8136-D-025	8136-L025 20
2.5 - 4.0	8136-L-040	8136-D-040	8136-L040 20
4.0 - 6.3	8136-L-063	8136-D-063	8136-L063 20
6.3 - 10.0	8136-L-100	8136-D-100	8136-L100 20
10.0 - 16.0	8136-L-160	8136-D-160	8136-L160 21
16.0 - 20.0	8136-L-200	8136-D-200	8136-L200 23
20.0 - 25.0	8136-L-250	8136-D-250	8136-L250 23
25.0 - 32.0	8136-L-320	8136-D-320	8136-L320 27

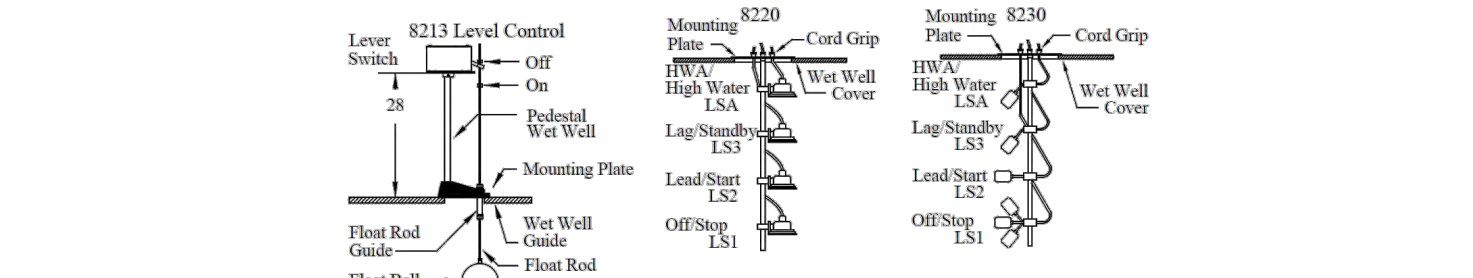

Options:
 8100K7102A HWA Dome Light - Lexan, red flashing, on top panel. Light remains on until condition is corrected. Type 4X
 How to Order: Specify Order Number, System Phase and Voltage, Pump Motor HP, and any options. F.O.B. Cedarburg (Milwaukee), Wisconsin

Replaces September 1, 2017 SN-8136 February 28, 2022 8136

WEIL Tethered Level Control 8233

Float Switch

The 8233 level controls utilize pole mounted tethered switches. The pole may be suspended from either a wet well cover or a bracket fastened to the wall of the wet well.
 Each tethered switch includes a cord grip and strap mount for mounting to a 3/4 inch or 1 inch pole.
 The 8233 tethered switch is normally open, closing on liquid rise. Use with Weil 8100 Control Panels. The switch is not rated for motor loads.
 - Single-pole switch has 16/2 cord with 2 wires, black/white
 - 115 volt, 3 amp pilot duty

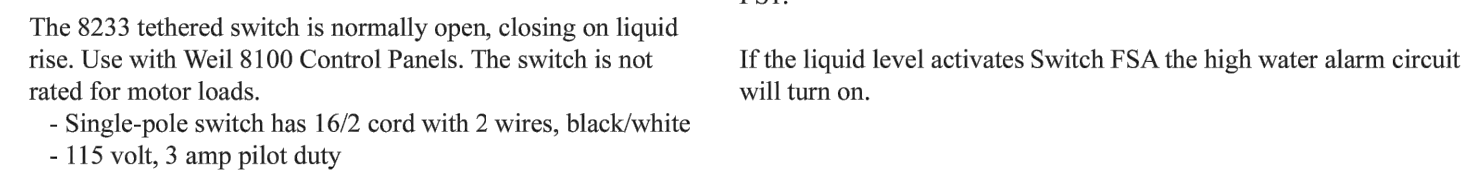

Order Number	Type of Assembly	Cord Length (Ft.)	Approx. Wt. (Lbs.)
8233K1006	Switch only with cord grip	20	4
8233K1014	Switch only with cord grip	40	6
8233K1016	Switch only with cord grip	60	8
8233K1018	Switch only with cord grip	80	10
8233K1020	Switch only with cord grip	100	12

8233 Options

Option	Description
314.399.000	Mounting Bracket - For sidewall suspends 3/4 inch pipe from wet well wall. Pipe Not included.
315.445.001	Mounting Plate - Round 8-inch diameter with four holes for level control cable cord grips. Suspends 3/4 or 1 inch pipe from mounting plate. Pipe Not included. Fastens to wet well cover with fasteners.
304.311.096	Mounting Pipe - 3/4 inch schedule 40, 10 feet long. Threaded on one end.
303.953.103	Mounting Pipe - 1 inch schedule 40, 10 feet long. Threaded on one end.

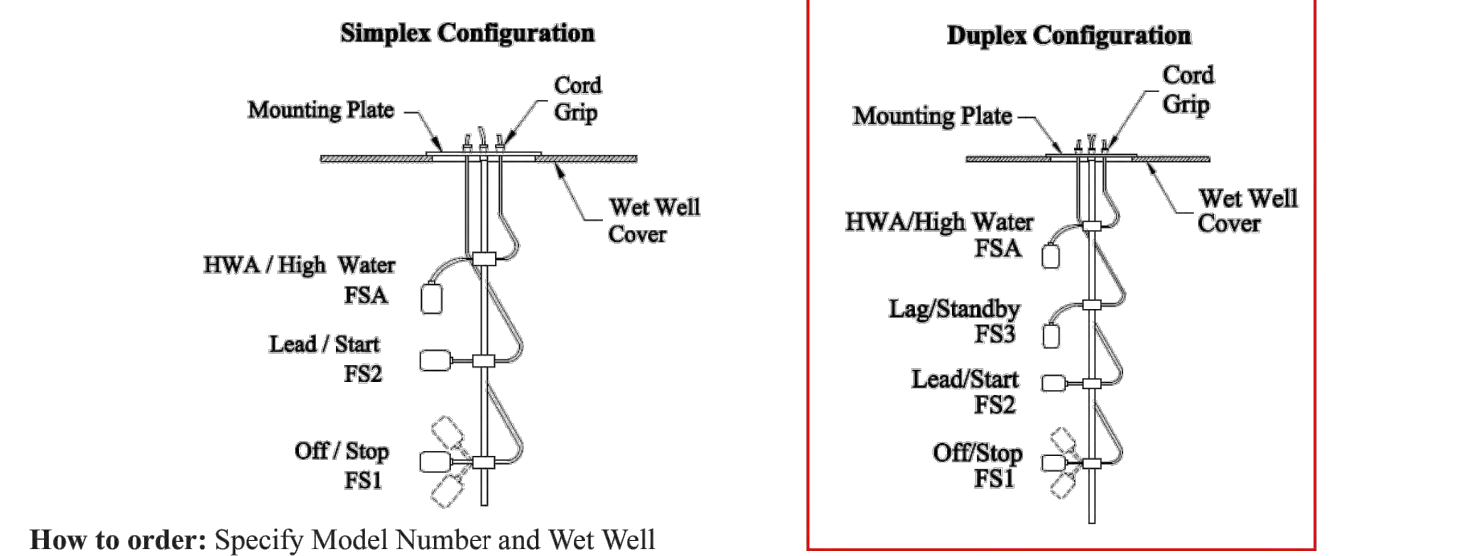

How to order: Specify Model Number and Wet Well Depth. F.O.B. Cedarburg (Milwaukee), Wisconsin

Replaces April 21, 2021 SN-8233 May 16, 2022 8233

WEIL Junction Box 8251

NEMA-6P

The 8251 Junction Box enclosure is made of hot-molded fiberglass reinforced polyester and is fully gasketed. The box can be mounted above the wet well cover.
 NEMA-6P - Indoor or outdoor use
 Provides a degree of protection against the entry of water during prolonged submersion at a max depth of 6 ft.
 Overall size 13 H x 11 W x 5 D
 The 8251 Junction Box has a 15 connection point connection terminal block.
 Hole and fitting for incoming power are not supplied by Weil.
 All motor sensor and level control switch cable holes are supplied with 1/2-inch NPT cord grips.
 Motor power cable hole cord grips will be supplied according to motor data furnished by customer.

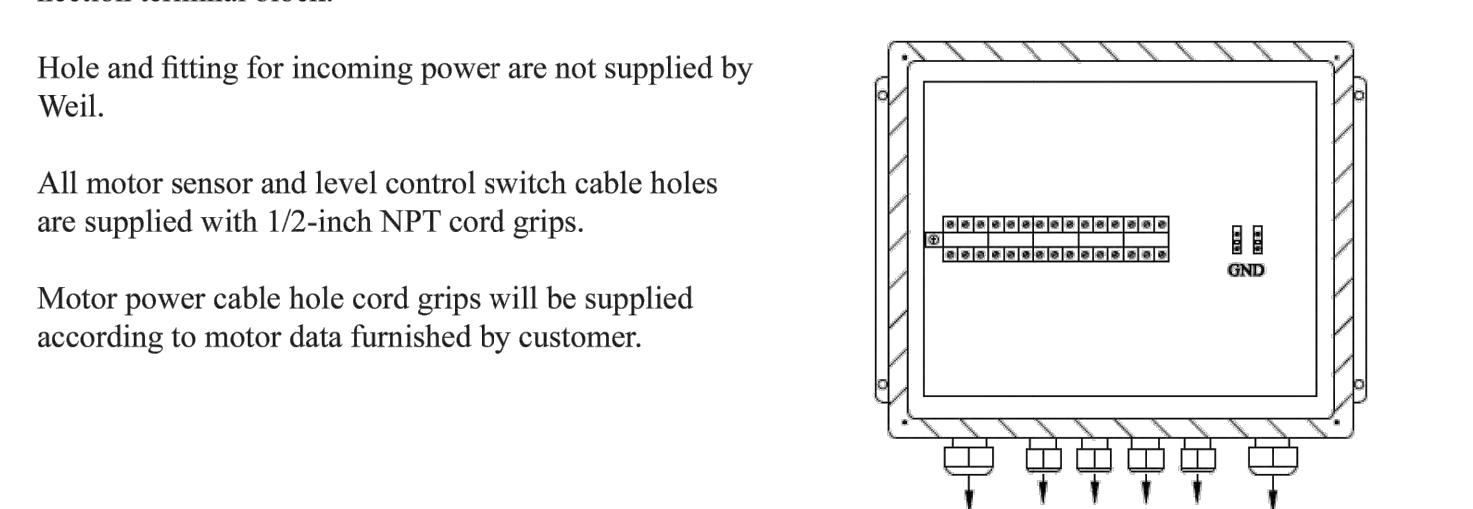
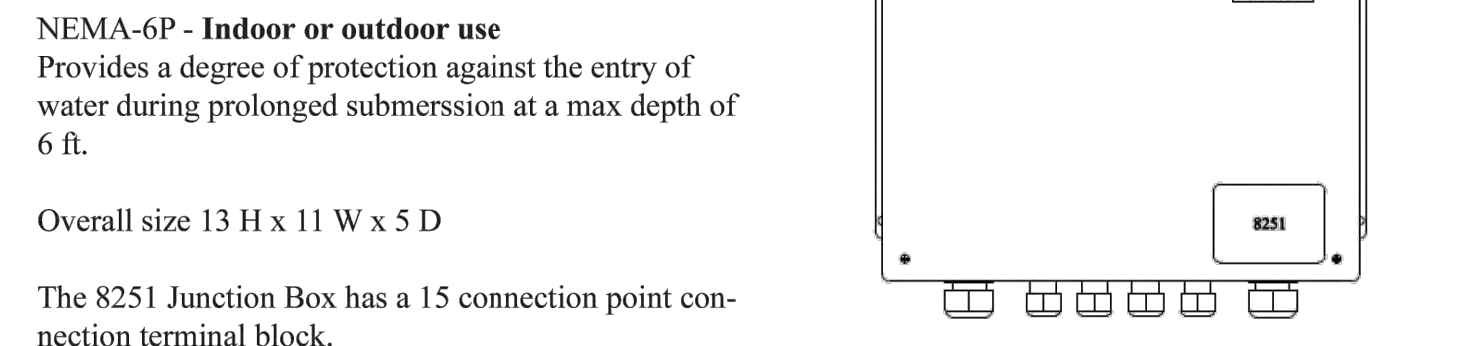

Simplex		Cord Grip Quantity			
Order Number	Motor	Level Control	Moisture/Temp Limiter Sensor	Total Holes	Weight Lbs.
W-8251S	1	-	-	1	8
W-8251S-S	1	-	1	2	8
W-8251S-F	1	3	-	4	9
W-8251S-FS	1	3	1	5	9

Duplex		Cord Grip Quantity			
Order Number	Motor	Level Control	Moisture/Temp Limiter Sensor	Total Holes	Weight Lbs.
W-8251D	2	-	-	2	10
W-8251D-S	2	-	2	4	10
W-8251D-F	2	4	-	6	11
W-8251D-FS	2	4	2	8	11

How to order: Specify Model Number F.O.B. Cedarburg (Milwaukee), Wisconsin

Replaces SN-8251 June 12, 2020 8251

DESIGNWORKSHOP

Landscape Architecture • Land Planning
 Urban Design • Tourism Planning
 Aspen • Austin • Chicago • Denver • Houston
 Lake Tahoe • Los Angeles • Raleigh

22860 Two Rivers Road
 Basalt, Colorado 81621
 (970) 925-8354

WWW.DESIGNWORKSHOP.COM

REED PARK IMPROVEMENTS

FRUITA, CO



ISSUE DATE: JUNE 15, 2023

REVISIONS	DATE	DESCRIPTION
1	08/03/23	CD REVISION 1

DRAWN: KA REVIEWED: BM

PERMIT SET

PROJECT NUMBER: 6961

PUMP DETAILS SHEET 1

SHEET NUMBER

C4-01